



INSTRUCTION BOOKLET FOR "LLAMA" AUTO PISTOLS

Congratulations . . . on your selection of a Llama Automatic pistol, product of the famous Gabilondo firm of Vitoria, Spain.

The Gabilondo firm, makers of automatic pistols and revolvers, is one of the world's largest manufacturers of handguns for sport and law enforcement purposes. Their new and modern plant in Vitoria, Spain, is equipped with the latest in metal shaping machinery and, supported by an excellent technical staff, the firm enjoys a world-wide reputation for quality.

To obtain the best possible performance and reliability from your new pistol, be sure to read this instruction booklet from cover to cover, and please pay special attention to the recommended safety procedures described on the following page.

Thank you and good shooting!

IMPORTANT SAFETY PROCEDURES

1. DO NOT carry or store your Llama automatic pistol with the hammer in the rest position against the firing pin. This is a firing attitude which prevents engagement of the safety devices and which may cause accidental discharge of the firearm. Always use the half-cock or full cock hammer position with the side safety in the "on" position.
2. WHEN LOADING THE CHAMBER: be sure to point the gun in a safe direction.
3. DO NOT CHARGE THE CHAMBER until you are ready to use the pistol.
4. ALWAYS EMPLOY THE SAFETY DEVICE WHEN THE CHAMBER IS LOADED. The safety should only be dis-engaged immediately prior to shooting.
5. WHEN STORING THE FIREARM MAKE SURE THE CHAMBER IS EMPTY. (If used as a weapon for self-defense, load the magazine and insert it in the gun, but, **do not** activate the bolt to load the chamber.)
6. BE CAREFUL TO AVOID DROPPING A LOADED PISTOL (a handgun must be designed to fire under the slight pressure exerted by the trigger finger. For this reason the engaging surfaces of the firing mechanism must be adjusted to close tolerances. The energy created by a falling handgun can, upon impact, easily cause dislodgement of these engaging surfaces and subsequent discharge of the loaded firearm.)
7. DO NOT POINT A FIREARM AT ANYTHING YOU DO NOT INTEND TO SHOOT.
8. BE CAREFUL OF YOUR BACKSTOP: know where the bullet will terminate its flight if it should miss the target.
9. DO NOT SHOOT AT THE SURFACE OF WATER OR AT HARD SURFACES, SUCH AS ROCKS, ETC. (such surfaces will invariably cause erratic ricochets).

CUT-AWAY VIEW OF LLAMA AUTOMATIC PISTOL

(Note: In this view we show the handgun at the instant of firing. This is the only time the hammer should come in contact with the firing pin. Never carry or store the Llama with the hammer in this position.)

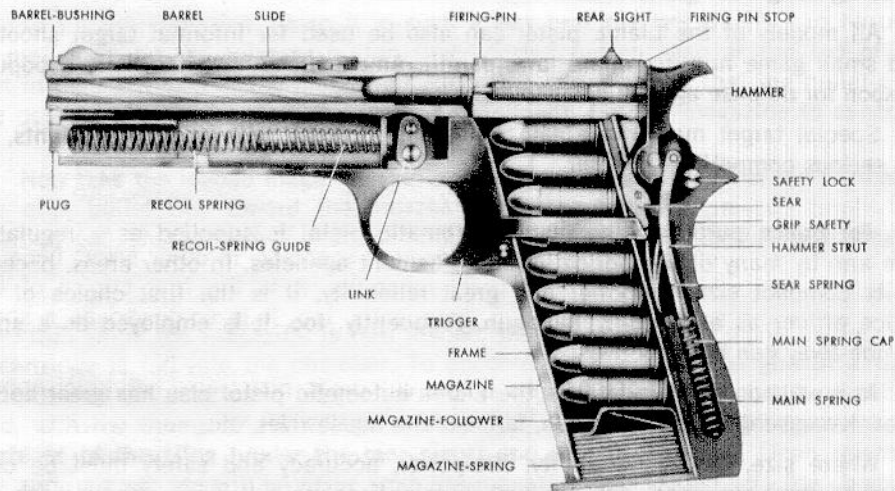

THE LLAMA AUTOMATIC PISTOL

... **for sporting purposes**, is an ideal sidearm for the hunter because it is small, light, and easily carried in a shoulder or belt holster. Its superb handling qualities and great fire-power provide the hunter with an added margin of safety when pursuing dangerous game.

All models of the Llama pistol can also be used for informal target shooting and small game hunting where laws permit. Among fishermen, too, it is a popular weapon for defense against poisonous snakes.

Special target models are also available, equipped with adjustable sights, for the serious competition shooter.

... **for police purposes**, the Llama automatic pistol is supplied as a regulation side arm by many of the world's law-enforcement agencies. In other areas, because of its compact size, firepower and great reliability, it is the first choice of the police officer as an off-duty handgun. Frequently, too, it is employed as a spare or hide-away gun by detectives.

As a weapon for self-defense the Llama automatic pistol also has great appeal to bank messengers, businessmen, farmers and housewives, etc.

Where size, weight, reliability, fire-power, accuracy and safety must be combined to meet the need, only a Llama automatic pistol will serve the purpose.

OPERATION OF THE LLAMA PISTOL

TO LOAD: depress the magazine button which is located immediately behind the trigger, on the left side of the gun as it is pointed. This will unlock the magazine which is housed inside the grip and which can now be removed.

To fill the magazine, grasp it in such a way that the left thumb can be used to pull down on the follower button (the knurled button seen at the top of the slot in the right side of the magazine). Place the cartridges so that the bullet ends are positioned over the leading edge of the follower. Fill the magazine to capacity.

Now take the loaded magazine and slide it back into the well at the bottom of the grip, bullet tips toward the muzzle. When magazine is pressed firmly into position you should hear a distinct "click" which indicates that it is locked in place.

TO FIRE: while the magazine is now loaded, the gun cannot be made to fire until a cartridge is fed into the chamber. To accomplish this, hold the gun in a firing attitude (do not touch the trigger and be careful to point it in a safe direction) and, with the thumb and forefinger of the opposite hand, grasp the grooved rear surfaces of the slide (under the rear sight) and pull back firmly. Upon releasing the slide a cartridge will be lifted from the magazine and loaded into the chamber.

CAUTION: the weapon is now in a firing attitude with the hammer in the full-cock position. BE SURE TO ENGAGE THE SIDE SAFETY IF YOU DO NOT INTEND TO SHOOT. The side safety is illustrated as part #127 in plate D. In plate D, too, you will see the safety lever in the "safe" position. In plate F the safety is in the "fire" position.

(Continued on next page)

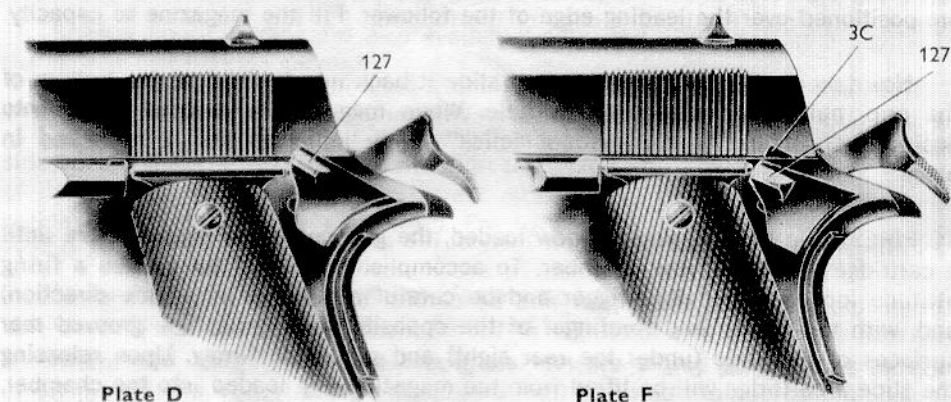

OPERATION OF THE LLAMA PISTOL (Continued)

If you wish to store the loaded weapon, or carry it in a holster, we strongly recommend that you place it in the half-cock position with the side safety in the "safe" position. To lower the hammer to the half-cock, simply hold the gun in a firing attitude while pointing it in a safe direction. Now, with the safety in the fire position, grasp the hammer spur firmly between the thumb and forefinger of the free hand and, while exerting slight pressure on the trigger, **gently** lower the hammer to the half-cock position, release the trigger and immediately engage the side safety. Practice this with an empty chamber!

SAFETY DEVICES: the Llama automatic pistol is made with three positive safety devices and is the safest of all automatic pistols if properly handled. First, it has a grip safety which, when the hammer is in the half-cock or full-cock position, will prevent discharge except when deliberately grasped in a firing attitude. Next, it has a half-cock safety position which will prevent discharge even when grasped in a firing attitude with pressure exerted upon the trigger. Finally, it has a side-lever safety (#127) which prevents firing under any circumstances as long as the hammer is in half-cock or full-cock.

IMPORTANT NOTE: the hammer should never be lowered to the "fire" position, resting against the rear surface of the firing pin because **NONE OF THE SAFETY DEVICES CAN BE ENGAGED WHEN IN THIS ATTITUDE!**

HOW TO DISASSEMBLE THE LLAMA PISTOL

The Llama pistol is quite easily taken apart; the parts mentioned in the following instruction refer to those described and illustrated in plate 1 at the back of this booklet:

1. Use the left thumb to depress the knurled magazine catch (#146) and withdraw the magazine (#147).
2. Depress the muzzle plug (#139) and, at the same time rotate the barrel bushing (#136) a quarter turn toward the right side of the gun. (See plates G & H).
3. Pull back the slide (#116) until its notch (plate Y position 3b) coincides with the tip of the lever (#137, plate Y position 8a). The tip of the lever must fit into the notch of the slide. Now, on the opposite side of the gun will be seen the button-like projection of the lever (#137) — push this in to facilitate removal of the lever (#137).
4. Once the lever is withdrawn, the slide, barrel, recoil spring and guide may be removed by simply sliding them towards the muzzle. (See plate J). With the slide free of the frame, turn it over so that you can remove the recoil spring and guide. Next, remove the barrel bushing (#136) and the barrel (#117) by turning them slightly and drawing them out of the front of the slide.
5. The grips can be removed by simply unscrewing the grip screws. Your Llama pistol is now completely field-stripped and can easily be cleaned by brushing with a soft bristle brush moistened with a mild cleaning solvent. Be sure to remove all traces of the cleaning solution, and oil all parts lightly before re-assembling. **DO NOT ATTEMPT ANY FURTHER DIS-ASSEMBLY OF YOUR LLAMA PISTOL!**

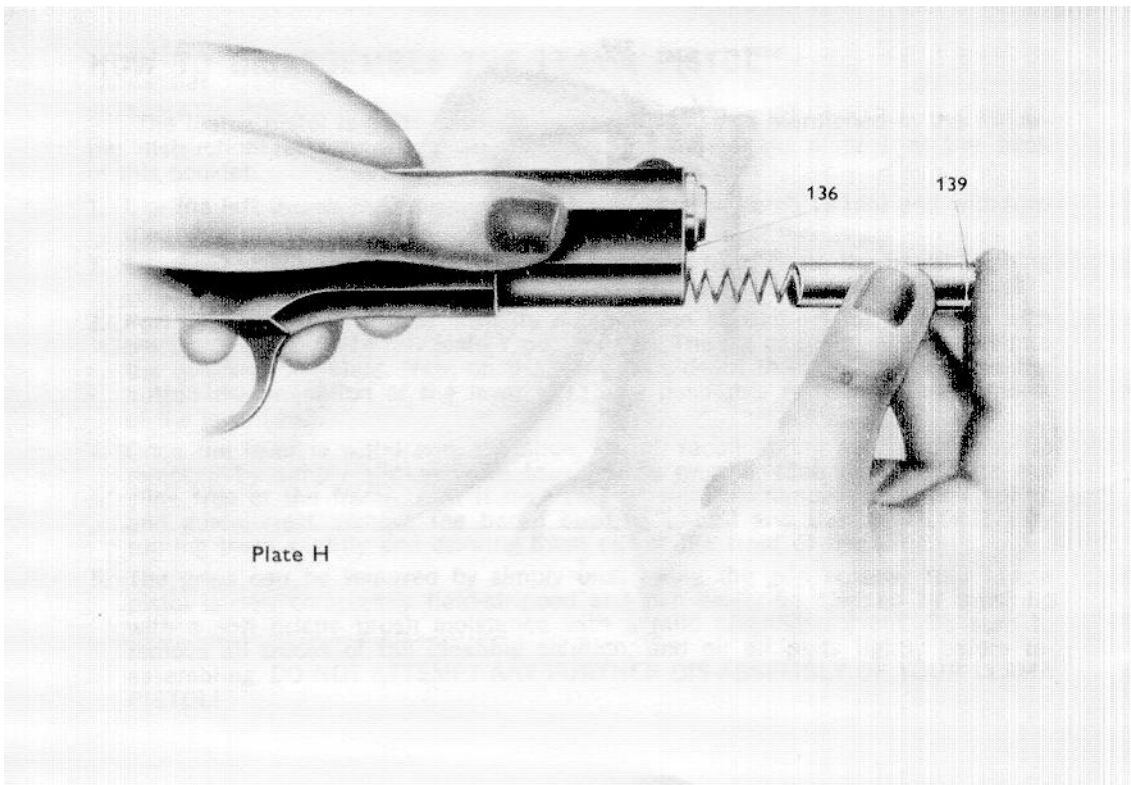
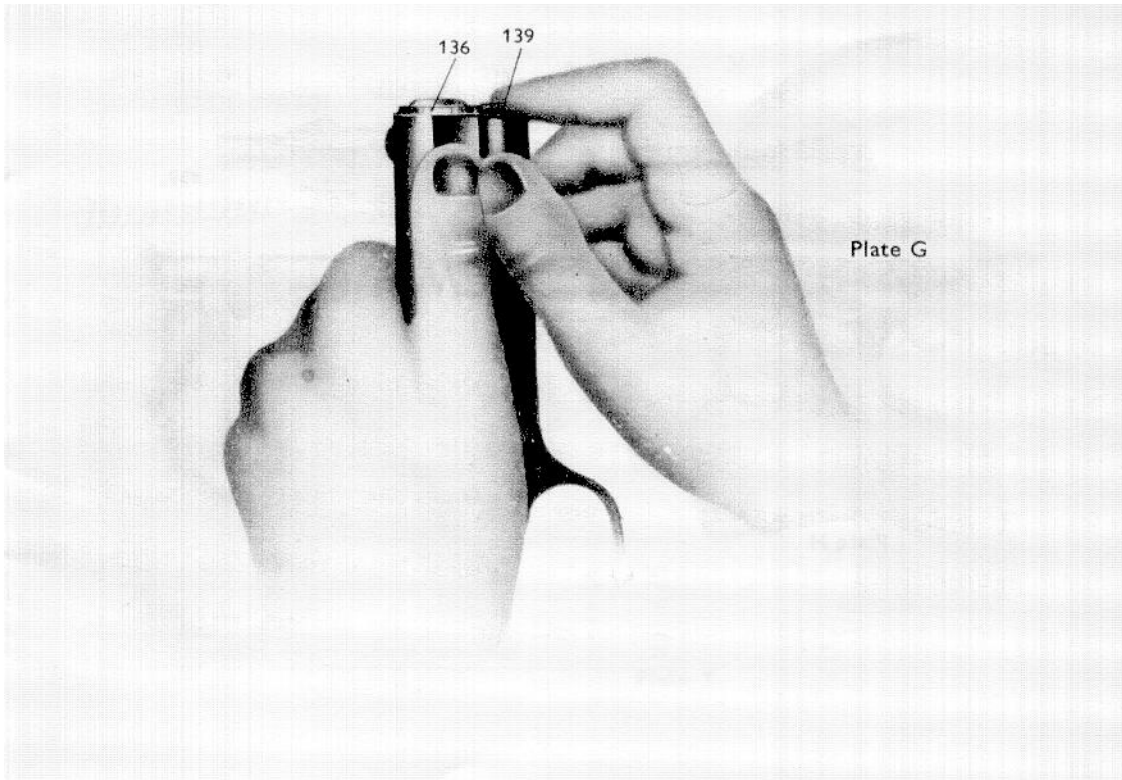

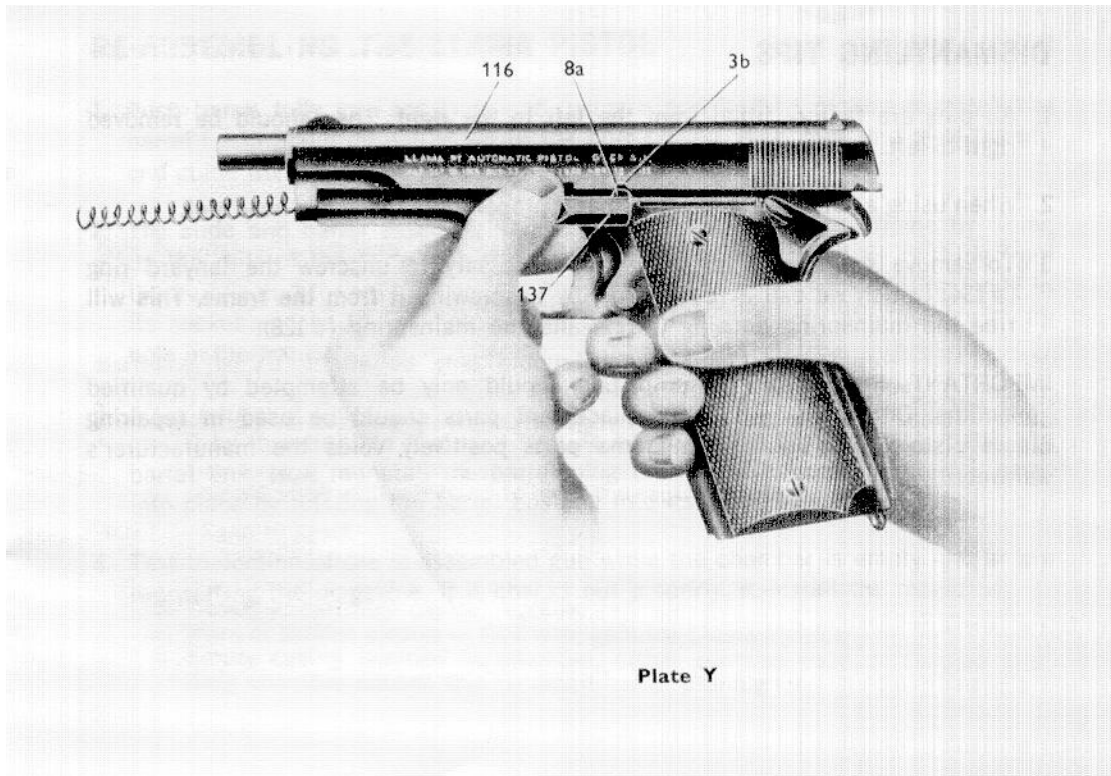

DISMANTLING TIPS

1. All pins are factory fitted from the left to the right. They should be removed right-to-left.
2. When using a screwdriver, be sure that it properly fits the screw-head slot.
3. To remove mainspring housing, it is necessary to unscrew the lanyard ring (#134) (which we call a "cord ring") by unscrewing it from the frame. This will free the mainspring housing (#129) and the mainspring (#128).

IMPORTANT: Repairs on Llama pistols should only be attempted by qualified gunsmiths. Only genuine Llama replacement parts should be used in repairing Llama pistols. The use of non-Llama parts positively voids the manufacturer's warranty.

RE-ASSEMBLING THE LLAMA PISTOL

1. Push barrel fully into the slide and, using a quarter-turn motion re-install the barrel bushing but do not as yet fit the plug (#139). Now, re-fit the recoil spring and guide from the chamber end of the slide.
2. The slide and barrel assembly should now be inserted in the frame by lining up the rails of the slide with the tracks in the frame. Install by pushing from the muzzle end toward the hammer. Be careful to align the recoil spring guide in its socket and to fit the hole in the barrel link in proper alignment with its hole in the frame.
3. After returning the slide to its normal position on the frame, re-fit the lever (#137) by inserting the lever pin thru its corresponding holes in the frame and barrel link. Now re-install the barrel plug (#139) in its socket and lock same into place by rotating the barrel bushing into its normal position.
4. Test the action of the re-assembled gun while the chamber is empty and before re-inserting the magazine. If it checks out properly, re-install the magazine.

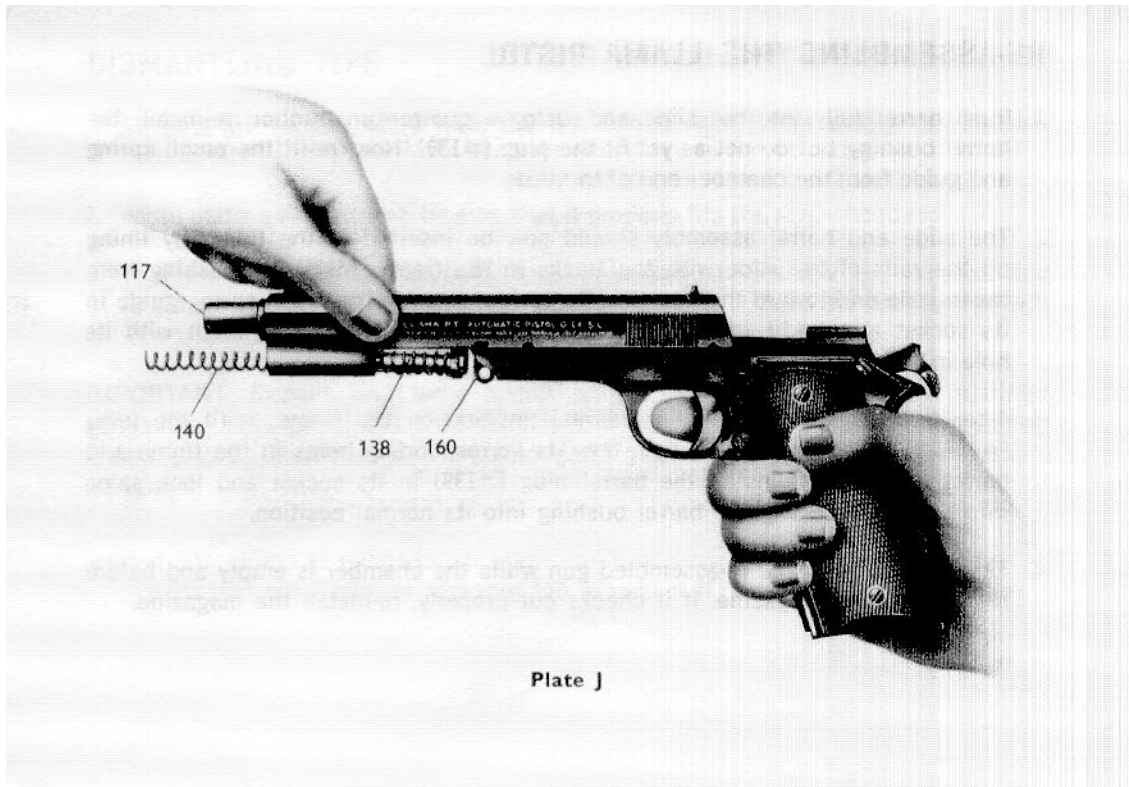

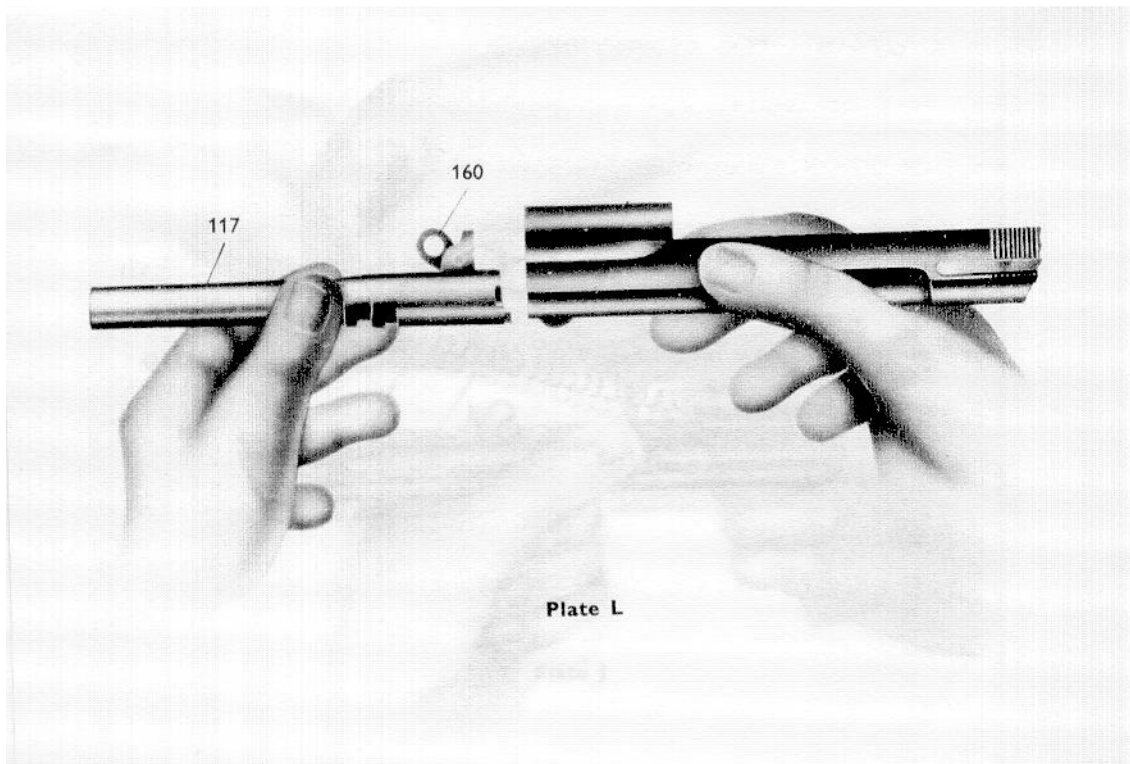
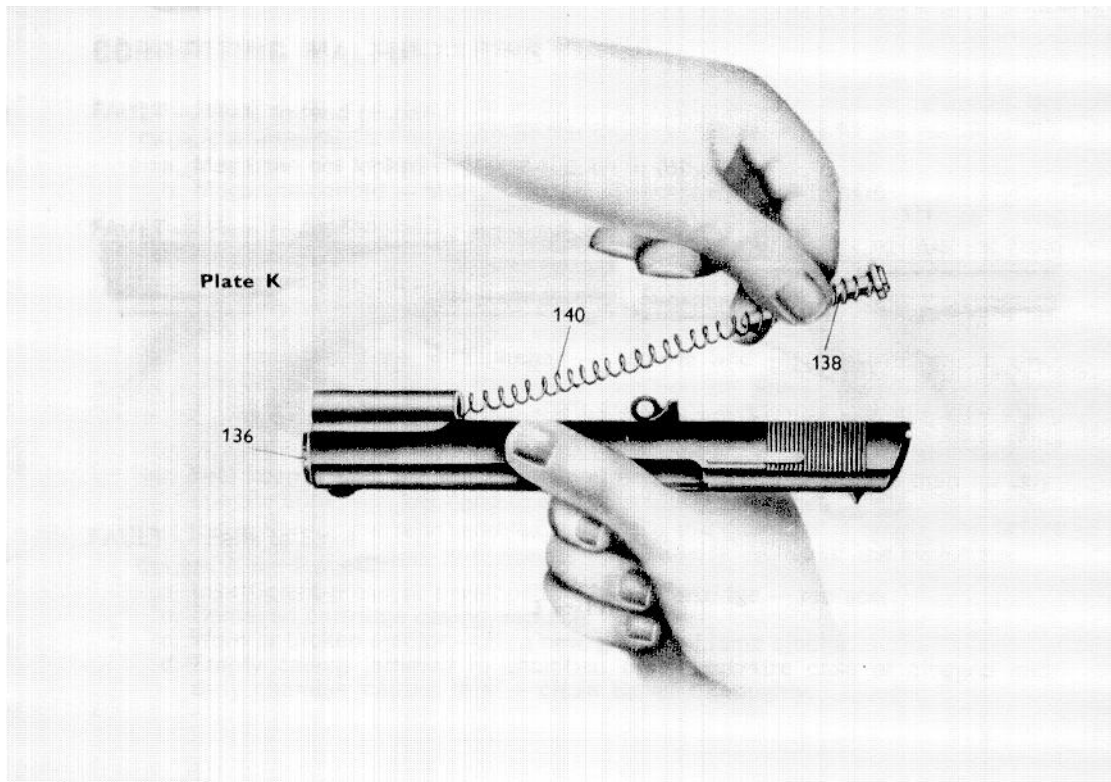

CORRECTING MALFUNCTIONS

FAULT — Fails to feed properly

Causes & remedies —

- a. Magazine not locked in place — push in fully.
- b. Magazine dented — straighten and, if necessary, true-up ears.

FAULT — Fails to fire

Causes & remedies —

- a. Hammer not at full cock — cock hammer fully rearward.
- b. A safety is engaged or firearm is not properly gripped — hold firmly in shooting attitude and release side safety.
- c. Defective cartridge in chamber — remove and replace with clean, dry, live cartridge.
- d. Firing pin is broken or worn from excessive use — have a **qualified gunsmith** re-fit a new genuine Llama firing pin.
- e. When gun fails to fire, re-cock hammer and try it again. If it still fails to fire, keep it pointed in a safe direction, wait one minute and then quickly operate slide with left hand to eject the faulty cartridge.

FAULT — Fails to Eject

Causes & remedies —

- a. Insufficient pressure developed by faulty cartridge — replace.
- b. Damaged cartridge casing, replace.
- c. Worn or broken ejector — fit a new, genuine Llama ejector.
- d. Empty casing jammed in chamber, either oversize case or clogged and dirty chamber causes this — clean barrel thoroughly.

LLAMA Super .38 & .45 Caliber AUTOMATIC PISTOL

BIG, HARD-HITTING
MILITARY & POLICE
WEAPON.

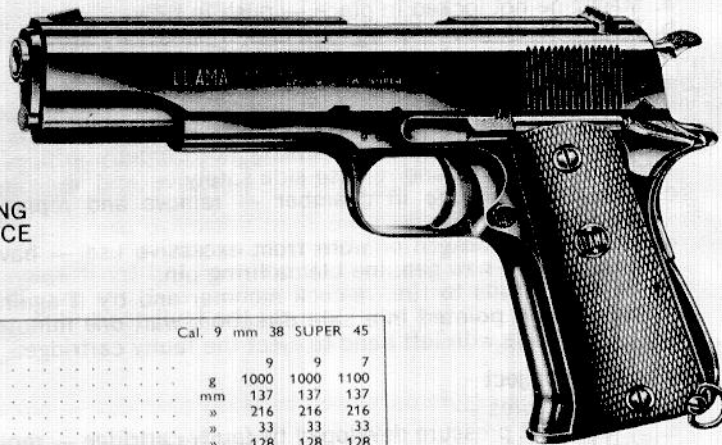

		Cal. 9 mm 38 SUPER 45		
Number of Shots		9	9	7
Weight of Pistol	g	1000	1000	1100
Height of Pistol	mm	137	137	137
Length of Pistol	»	216	216	216
Thickness of Butt	»	33	33	33
Length Barrel	»	128	128	128
Power of penetration into pine-wood at 15 metres range	»	218	218	106
Effective range	m	800	800	500

LLAMA
.380 Caliber
AUTOMATIC PISTOL

MODEL III-A

COMPACT, HARD-HITTING
 DEFENSE & POLICE
 WEAPON

CALIBER 9 mm SHORT (380) AUTO

Number of Shots	7
Weight of Pistol	585 gr
Height of Pistol	110 mm
Length of Pistol	» 160
Thickness of Butt	» 27
Length barrel	» 94
Power of penetration into pinewood at 25 metres range	» 70



LLAMA
.32 Caliber
AUTOMATIC PISTOL

MODEL X-A

COMPACT SPORT,
 DEFENSE & UNDERCOVER
 WEAPON

CALIBER 7,65 mm (32) AUTO

Number of Shots	8
Weight of Pistol	600 g
Height of Pistol	110 mm
Length of Pistol	» 160
Thickness of Butt	» 27
Length barrel	» 94
Power of penetration into pinewood at 25 metres range	» 75



LLAMA
.22 Caliber
AUTOMATIC PISTOL

MODEL XV

COMPACT
 SPORT
 MODEL

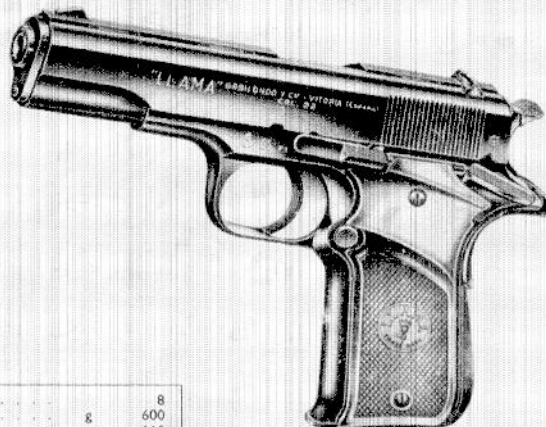

CALIBER 22 (Long Rifle) AUTO

Number of Shots	8
Weight of Pistol	600 g
Height of Pistol	110 mm
Length of Pistol	160 mm
Thickness of Butt	27 mm
Length barrel	94 mm

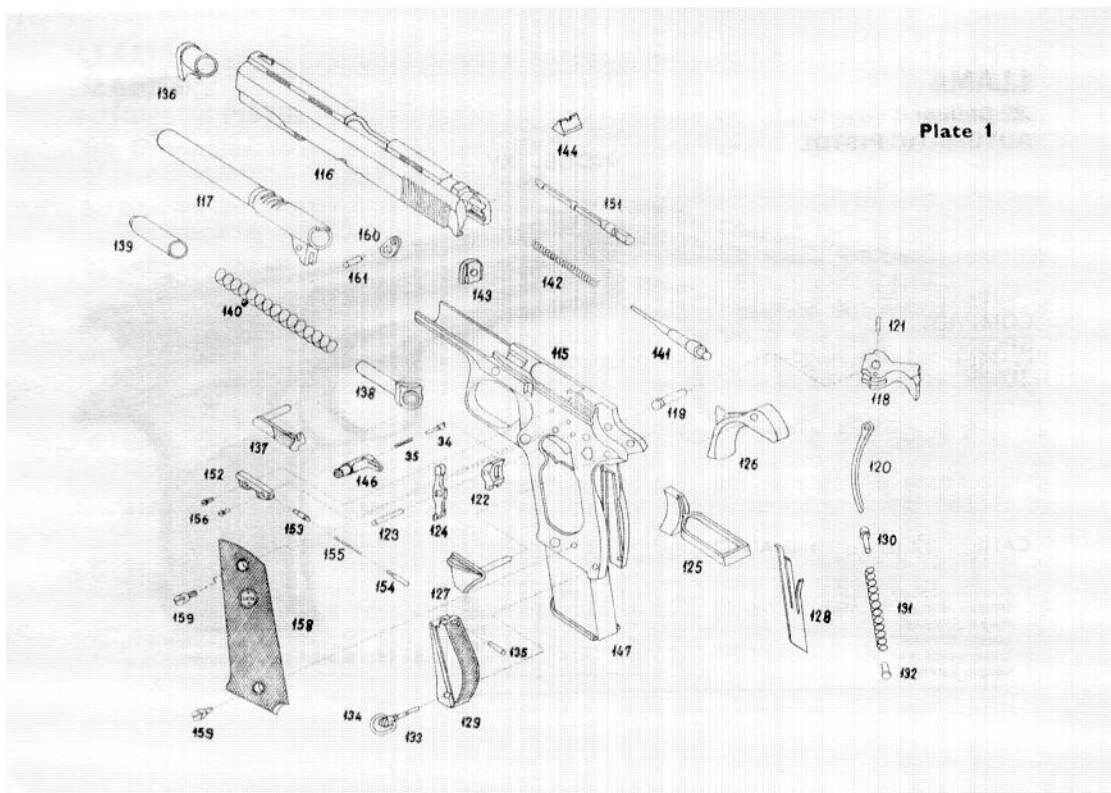

«LLAMA» PARTS FOR CAL. 9 mm BERGMANN, .38 SUPER & .45 AUTO PISTOLS

- | | |
|------------------------------|---------------------------|
| 115 Frame. | 137 Slide stop. |
| 116 Slide. | 138 Recoil spring guide. |
| 117 Barrel. | 139 Plug. |
| 118 Hammer. | 140 Recoil spring. |
| 119 Hammer pin. | 141 Firing pin. |
| 120 Hammer strut. | 142 Firing pin spring. |
| 121 Hammer strut pin. | 143 Firing pin stop. |
| 122 Sear. | 144 Rear sight. |
| 123 Sear pin. | 146 Magazine catch. |
| 124 Disconnecter. | 34 Magazine catch lock. |
| 125 Trigger. | 35 Magazine catch spring. |
| 126 Grip safety. | 147 Magazine. |
| 127 Safety lock. | 151 Extractor. |
| 128 Sear spring. | 152 Plunger tube. |
| 129 Main spring housing. | 153 Slide stop plunger. |
| 130 Main spring cap. | 154 Safety lock plunger. |
| 131 Main spring. | 155 Plunger spring. |
| 132 Spring stop. | 156 Plunger screw. |
| 133 Main spring housing pin. | 158 Stocks. |
| 134 Cord ring. | 159 Stocks screw. |
| 135 Main spring cap pin. | 160 Barrel link. |
| 136 Barrel bushing. | 161 Barrel link pin. |

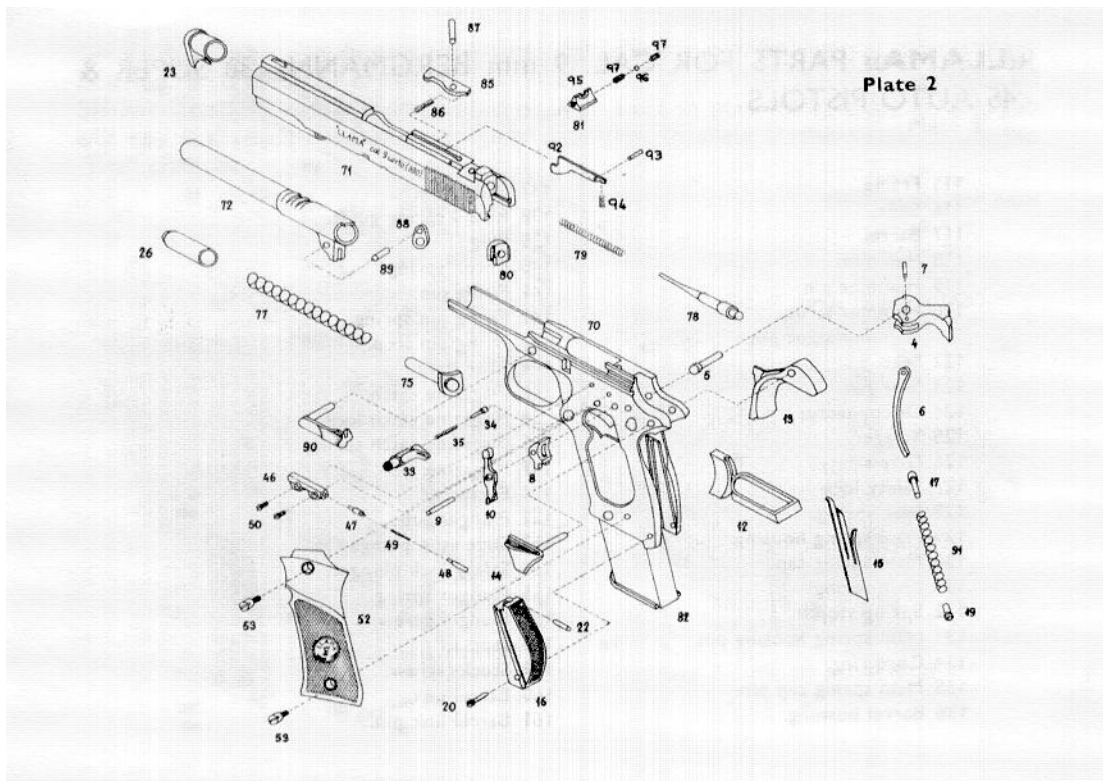

«LLAMA» PARTS FOR CAL. 9 mm SHORT (.380) AUTO PISTOL

- | | |
|-----------------------------|------------------------------|
| 70 Frame. | 78 Firing pin. |
| 71 Slide. | 79 Firing pin spring. |
| 72 Barrel. | 33 Magazine catch. |
| 4 Hammer. | 34 Magazine catch lock. |
| 5 Hammer pin. | 35 Magazine catch spring. |
| 6 Hammer strut. | 82 Magazine. |
| 7 Hammer strut pin. | 85 Extractor. |
| 8 Sear. | 86 Extractor spring. |
| 9 Sear pin. | 87 Extractor pin. |
| 10 Disconnecter. | 46 Plunger tube. |
| 12 Trigger. | 47 Slide stop plunger. |
| 13 Grip safety. | 48 Safety lock plunger. |
| 14 Safety lock. | 49 Plunger spring. |
| 15 Sear spring. | 50 Plunger screw. |
| 16 Main spring housing. | 52 Stocks. |
| 17 Main spring cap. | 53 Stocks screw. |
| 91 Main spring. | 88 Barrel link. |
| 19 Spring stop. | 83 Barrel link pin. |
| 20 Main spring housing pin. | 80 Firing pin stop. |
| 22 Main spring cap pin. | 92 Loaded chamber indicator. |
| 23 Barrel bushing. | 93 Indicator pin. |
| 90 Slide stop. | 94 Indicator spring. |
| 75 Recoil spring guide. | 95 Adjustable sight. |
| 26 Plug. | 96 Adjustable sight ball. |
| 77 Recoil spring. | 97 Adjustable sight screws. |

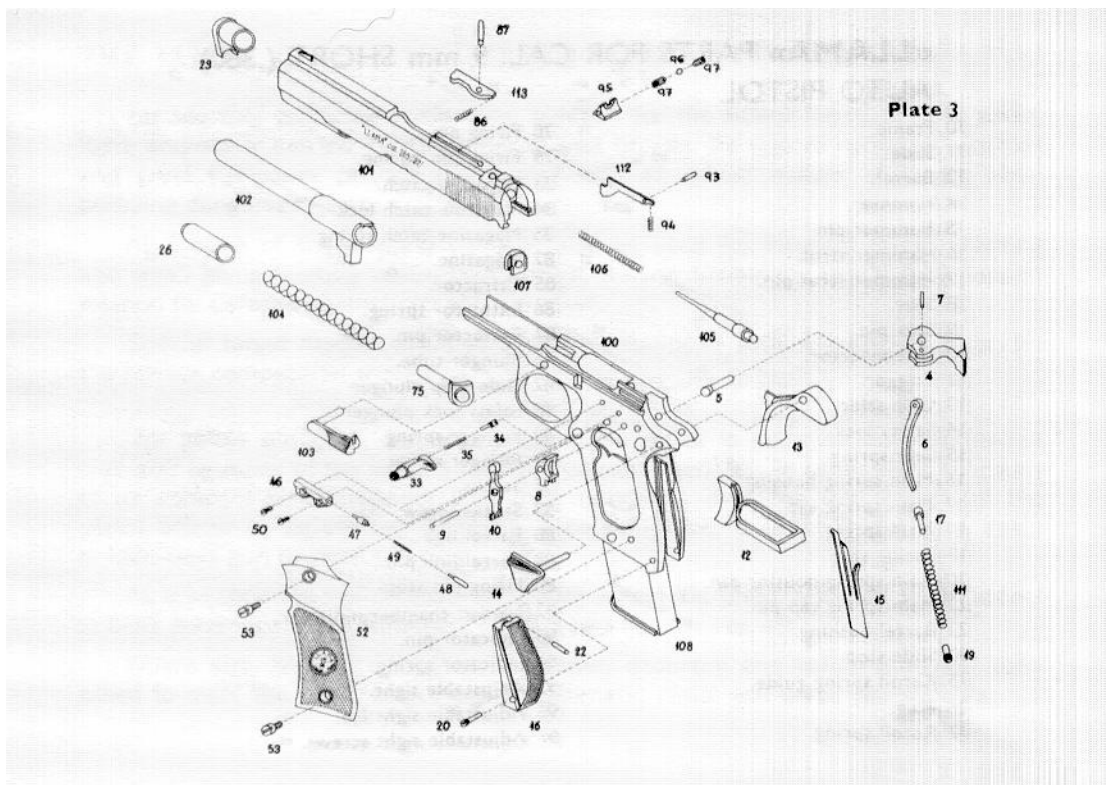

«LLAMA» PARTS FOR CAL. 7.65 mm (.32) AUTO PISTOL

- | | |
|-----------------------------|-------------------------------|
| 100 Frame. | 104 Recoil spring. |
| 101 Slide. | 105 Firing pin. |
| 102 Barrel. | 106 Firing pin spring. |
| 4 Hammer. | 33 Magazine catch. |
| 5 Hammer pin. | 34 Magazine catch lock. |
| 6 Hammer strut. | 35 Magazine catch spring. |
| 7 Hammer strut pin. | 108 Magazine. |
| 8 Sear. | 113 Extractor. |
| 9 Sear pin. | 86 Extractor spring. |
| 10 Disconnect. | 87 Extractor pin. |
| 12 Trigger. | 48 Plunger tube. |
| 13 Grip safety. | 47 Slide stop plunger. |
| 14 Safety lock. | 48 Safety lock plunger. |
| 15 Sear spring. | 49 Plunger spring. |
| 16 Main spring housing. | 50 Plunger screw. |
| 17 Main spring cap. | 52 Stocks. |
| 111 Main spring. | 53 Stocks screw. |
| 19 Spring stop. | 107 Firing pin stop. |
| 20 Main spring housing pin. | 93 Indicator pin. |
| 22 Main spring cap pin. | 94 Indicator spring. |
| 23 Barrel bushing. | 95 Adjustable sight. |
| 103 Slide stop. | 96 Adjustable sight ball. |
| 75 Recoil spring guide. | 97 Adjustable sight screws. |
| 26 Plug. | 112 Loaded chamber indicator. |

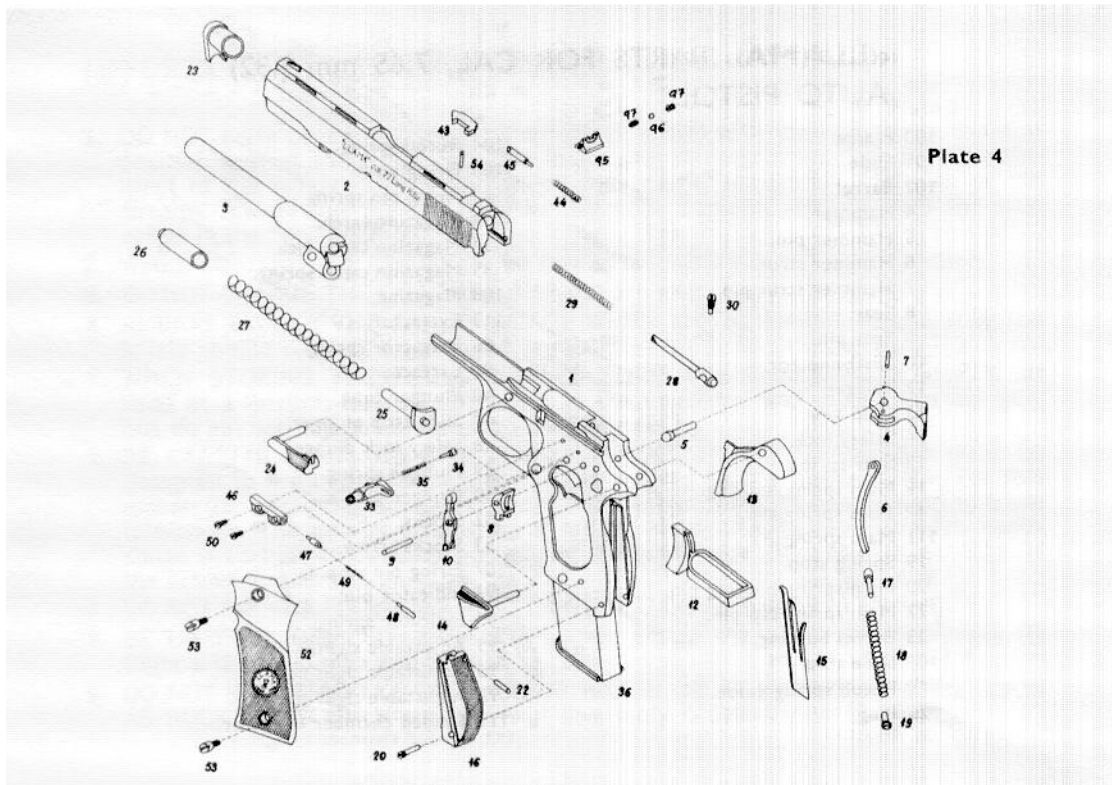
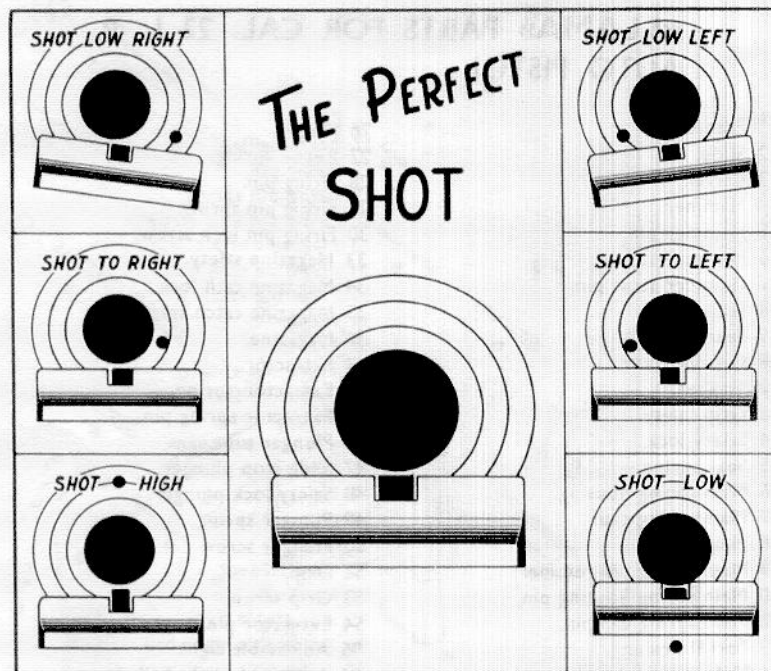

Plate 4

«LLAMA» PARTS FOR CAL. 22 L. R. AUTO PISTOL

- | | |
|------------------------------|-----------------------------|
| 1 Frame. | 26 Plug. |
| 2 Slide. | 27 Recoil spring. |
| 3 Barrel. | 28 Firing pin. |
| 4 Hammer. | 29 Firing pin spring. |
| 5 Hammer pin. | 30 Firing pin lock screw. |
| 6 Hammer strut. | 33 Magazine safety. |
| 7 Hammer strut pin. | 34 Magazine catch lock. |
| 8 Sear. | 35 Magazine catch spring. |
| 9 Sear pin. | 36 Magazine. |
| 10 Disconnect. | 43 Extractor. |
| 12 Trigger. | 44 Extractor spring. |
| 13 Grip safety. | 45 Extractor spring pin. |
| 14 Safety lock. | 46 Plunger tube. |
| 15 Sear spring. | 47 Slide stop plunger. |
| 16 Main spring housing. | 48 Safety lock plunger. |
| 17 Main spring cap. | 49 Plunger spring. |
| 18 Main spring. | 50 Plunger screw. |
| 19 Main spring pin retainer. | 52 Grip. |
| 20 Main spring housing pin. | 53 Grip screw. |
| 22 Main spring cap pin. | 54 Extractor pin. |
| 23 Barrel bushing. | 95 Adjustable sight. |
| 24 Slide stop. | 96 Adjustable sight ball. |
| 25 Recoil spring guide. | 97 Adjustable sight screws. |





LLAMA - GABILONDO Y CIA. S. A.

VITORIA (SPAIN)