

**VERY IMPORTANT:** Save This Booklet. Carefully read all the cautions and instructions in this manual before using your new Browning Firearm.

# A-500

**BROWNING A-500  
SEMI-AUTOMATIC  
SHOTGUN**

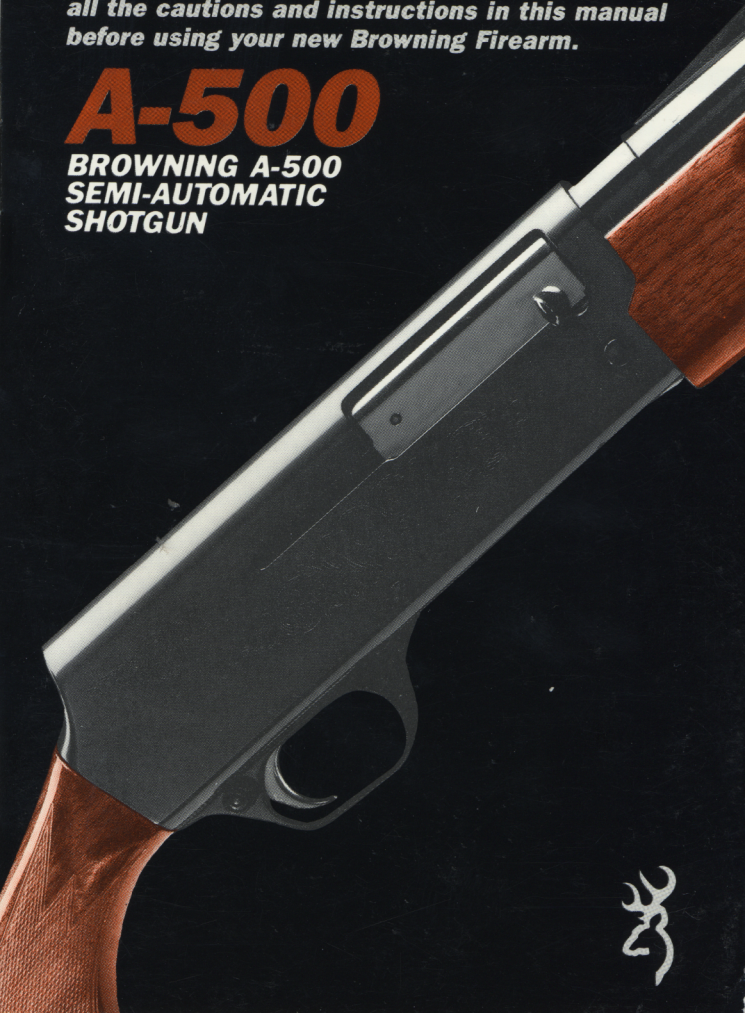

***We are pleased that you have chosen a  
Browning A-500 shotgun.***

It is certainly a gun you can be proud to own. It represents the state-of-the-art in modern gun design and manufacturing. The processes of design, testing and manufacturing were all assisted by advanced computer systems. The result is superior dependability, greater ease-of-operation, smoother handling and more reliable overall function. With a reasonable amount of care, your A-500 shotgun should give you many years of dependable, enjoyable service. Please feel free to write us immediately if you have any observations regarding its performance and operation.

Also, please take a moment to complete and mail in the brief attached marketing survey card found on our back cover. It helps us considerably in our constant effort to provide you with better service.

**NOTE:** All current production A-500 shotguns have an improved trigger group assembly. You can confirm this by the letter "H" stamped on the trigger guard. (See Figure 10 on page 37 of this manual.)

If your trigger guard does not have the letter "H" stamped on it then please contact our Browning Service Department toll free at 1-800-322-4626 for information on how to get the improved trigger assembly installed on your A-500.

Thank You.

*Route #1 Morgan, Utah 84050*

# ***You Are Responsible for Firearms Safety***

As a gun owner, you accept a set of demanding responsibilities. How seriously you take these responsibilities can be the difference between life and death. Mistakes made with guns are final and cannot be paid for with money or regret.

There is no excuse for careless or abusive handling of any firearm. At all times handle your shotgun and any other firearm with intense respect for its power and potential danger.

***PLEASE READ AND UNDERSTAND ALL OF THE CAUTIONS, PROPER HANDLING PROCEDURES AND INSTRUCTIONS OUTLINED IN THIS BOOKLET BEFORE USING YOUR NEW FIREARM.***



***ALWAYS KEEP THE MUZZLE OF YOUR SHOTGUN POINTED IN A SAFE***

***DIRECTION*** even though you are certain the shotgun is unloaded. Never point any firearm at anything you do not intend to shoot. Be extremely alert and aware of all persons and property within the range of your ammunition.



***NEVER TRUST YOUR SHOTGUN'S MECHANICAL "SAFETY" DEVICE.*** The

word “safety” describes a gun’s trigger block mechanism, sear block mechanism, hammer block mechanism or firing pin block mechanism. These mechanical devices are designed to place your gun in a SAFER status. No guarantee can be made that the gun will not fire even if the “safety” is in the “on safe” position. The A-500 has a cross bolt “safety” which blocks the gun’s trigger. See “Operation of the Safety” on page 15 for instructions on operation of this gun’s safety.

Like any mechanical device, a “safety” can sometimes fail; it can be jarred or inadvertently manipulated into an unsafe condition. Mechanical “safeties” merely aid safe gun handling and are no excuse for pointing your shotgun’s muzzle in an unsafe direction.

While it is a good idea to “test” your shotgun’s mechanical “safeties” periodically for proper function, **NEVER TEST THE “SAFETY” WHILE YOUR SHOTGUN IS LOADED OR POINTED IN AN UNSAFE DIRECTION.**

Safe gun handling does not stop with your gun’s mechanical “safety” devices it starts there. Always treat this shotgun with the respect due a loaded, ready-to-fire firearm.

**3**

**WHENEVER YOU HANDLE A FIREARM, OR HAND IT TO SOMEONE, ALWAYS OPEN THE ACTION IMMEDIATELY VISUALLY CHECK YOUR SHOTGUN'S CHAMBER, FEED MECHANISM AND MAGAZINE** to be certain that they do not

Inadvertently contain any ammunition. Always keep the chamber empty and the "safety" in the "on safe" position unless shooting is imminent.

**4**

**DO NOT TRANSPORT YOUR SHOTGUN LOADED, WHETHER IN A SCABBARD GUN CASE, OR OTHER CONTAINER.**

**5**

**BE WARE OF BARREL OBSTRUCTIONS,** for the safety of both your gun and yourself. Mud, snow, and an infinite variety of other objects may inadvertently lodge in a barrel bore. It takes only one small obstruction to cause dangerously increased pressures that can ruin (swell or rupture) the finest shotgun barrels.

**BEFORE CHECKING FOR A BARREL OBSTRUCTION, BE CERTAIN NO LIVE ROUND IS IN THE CHAMBER AND THAT THE MAGAZINE AND FEED MECHANISMS ARE COMPLETELY EMPTY. PLACE THE "SAFETY" IN THE "ON SAFE" POSITION** (See page 28 instructions on unloading). After assuring

yourself that the shotgun is completely empty, again, open the breechblock, locking it to the rear, and look through the barrel to be sure it is clear of any obstruction. If an obstruction is seen, no matter how small it may be, clean the bore with a cleaning rod and patch as described in “Cleaning and Maintenance Suggestions” on page 54.

Before the first firing, clean the bore with a cleaning rod and patch, and wipe away any anti-rust compounds in the action/chamber areas.

**6** ***ALWAYS UNLOAD YOUR SHOTGUN WHEN NOT IN USE. REFER TOPAGE 28 OF THIS INSTRUCTION BOOKLET EXPLAINING THE UNLOADING OF YOUR SHOTGUN.***

As a safety precaution, it is preferable to disassemble your gun for storage. Store your gun and ammunition separately — well beyond the reach of children. Take safeguards to ensure your shotgun does not become available to untrained, inexperienced or unwelcome hands.

**7** ***USE THE PROPER AMMUNITION.*** The barrel and action of this shotgun have been made with substantial safety margins over the pressures developed by established American commercial loads. Nevertheless, Browning assumes no

liability for incidents which occur through the use of cartridges of nonstandard dimensions which develop pressures in excess of commercially available ammunition which has been loaded in accordance with standards established by SAAMI (Sporting Arms and Ammunition Manufacturers Institute).



**DO NOT PUT A 20 GAUGE SHELL IN A 12 GAUGE GUN.** Store all shells of different gauges in completely separate and well-marked containers. Do not store shells of mixed gauges in a common container or in your pockets. **EXAMINE EVERY SHELL YOU PUT IN YOUR GUN.**

The most certain way to bulge or rupture a barrel is to drop a 20 gauge shell into a 12 gauge chamber. The 20 gauge shell, unfortunately, will not fall completely through the barrel; its rim is caught by the front of a 12 gauge chamber. Your gun will misfire (with the chamber appearing to be empty). It is then possible to load a 12 gauge shell behind the 20 gauge shell. If the 12 gauge shell is then fired, the result will be a so-called “12-20 burst” which can cause extensive damage to your gun and possible serious injury to you.

**9**

**DO NOT USE 3" SHOTGUN SHELLS IN A BARREL WITH A 2 3/4" CHAMBER. THE SIZE OF THE CHAMBER IS INSCRIBED, ALONG WITH CHOKE DESIGNATIONS, ON THE SIDE OF THE BARREL.**

**10**

**DO NOT SNAP THE FIRING PIN ON AN EMPTY CHAMBER — THE CHAMBER MAY NOT BE EMPTY!**

Treat every gun with the respect due a loaded gun, even though you are certain the gun is unloaded.

**11**

**KEEP YOUR FINGERS AWAY FROM THE TRIGGER WHILE UNLOADING, LOADING** or until you are ready to shoot.

**12**

**BE SURE OF YOUR TARGET AND**

**BACKSTOP** particularly during low light periods. Know the range of your ammunition. Never shoot at water or hard objects.

**13**

**ALWAYS UNLOAD YOUR SHOTGUN'S CHAMBER BEFORE CROSSING A FENCE, CLIMBING A TREE, JUMPING A DITCH OR NEGOTIATING OTHER OBSTACLES.**

Refer to page 28 of this instruction book for instructions on the unloading of your shotgun. Never place your shotgun on or against a fence, tree, car, or other similar object.



**14*****WEAR EYE AND EAR PROTECTION WHEN SHOOTING.***

Unprotected, repeated exposure to gunfire can cause hearing damage. Wear ear protectors (shooting ear plugs or muffs) to guard against such damage. Wear shooting glasses to protect your eyes from flying particles. Also, wear eye protection when disassembling and cleaning your shotgun to prevent the possibility of springs, spring-tensioned parts, solvents or other agents from contacting your eyes.

**15*****DROPPING A LOADED GUN CAN CAUSE AN ACCIDENTAL DISCHARGE***

even with the “safety” in the “on safe” position. Be extremely careful while hunting or during any shooting activity, to avoid dropping any firearm.

**16*****IF YOUR SHOTGUN FAILS TO FIRE, KEEP THE MUZZLE POINTED IN A SAFE DIRECTION.***

Hold this position for a minimum of 30 seconds. Carefully open the action and remove the cartridge. If the primer is indented, the cartridge should be disposed of in a way that cannot cause harm. If the primer is not indented, your firearm should be examined by a qualified gunsmith and the cause of the malfunction should be corrected before further use.

**BE DEFENSIVE AND ON GUARD  
AGAINST UNSAFE GUN HANDLING**

**AROUND YOU AND OTHERS.** Don't be timid when it comes to gun safety. If you observe other shooters violating any of these safety precautions, politely suggest safer handling practices.

**BE CERTAIN YOUR SHOTGUN IS  
UNLOADED BEFORE CLEANING.**

Because so many gun accidents occur when a firearm is being cleaned, special and extreme care should be taken to be sure your gun is unloaded before disassembly, cleaning and reassembly. Keep ammunition away from the cleaning location. Never test the mechanical function of any firearm with live ammunition.

**EDUCATE AND SUPERVISE FIREARMS  
SAFETY TO ALL MEMBERS OF YOUR**

**FAMILY** — especially to children and nonshooters. Closely supervise newcomers to the shooting sports. Encourage enrollment in hunting/shooting safety courses.

**, NEVER DRINK ALCOHOLIC  
BEVERAGES OR TAKE ANY TYPE OF  
DRUGS BEFORE OR DURING  
SHOOTING** Your vision and judgment

could be dangerously impaired, making your gun handling unsafe to you and to others.

**21**

**READ AND HEED ALL WARNINGS** in this instruction book and on ammunition boxes. It is your responsibility to secure the most up-to-date information on the safe handling procedures for your Browning gun. Browning cannot assume any responsibility when unsafe or improper arms and ammunition combinations are used.

**22**

**PERIODIC MAINTENANCE — AVOID UNAUTHORIZED SERVICING.** *your* shotgun is a mechanical device which will not last forever, and as such, is subject to wear and requires periodic inspection, adjustment, and service. Browning firearms should be serviced by a Browning Recommended Service Center or by Browning's service facility in Arnold, Missouri. Browning cannot assume any responsibility for injuries suffered or caused by unauthorized servicing, alterations or modifications of Browning firearms. **IT CAN BE VERY DANGEROUS TO ALTER THE TRIGGER, SAFETY OR OTHER FIRING MECHANISM PARTS OF THIS OR ANY OTHER FIREARM.**

**BE CAREFUL!**

# Nomenclature

In conventional gun terminology, the position and movement of gun parts are described as they occur with the gun horizontal and in normal firing position; i.e., the muzzle is forward or front; butt stock is rearward or rear; trigger is downward or underneath; the rib is upward or on top. For general parts nomenclature refer to Figure 1-A. See Figure 1-B for names of all parts and assemblies covered in disassembly and cleaning procedures.

**FIGURE 1-A**

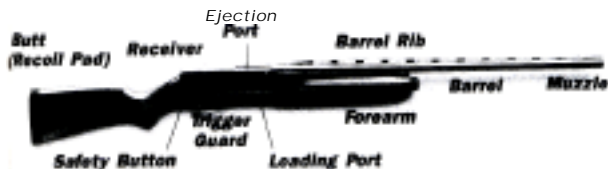

**FIGURE 1-B**



A. Barrel Extension Guides  
B. Barrel Ring Guide  
C. Front Action Springs  
D. Bolt Release Button  
(Carrier Latch Button)  
E. Breechblock Assembly  
F. Carrier  
G. Forearm  
H. Forearm Buffer Rings  
I. Magazine Tube  
J. Magazine Cap

K. Magazine Spring Retainer  
L. Magazine Follower  
M. Magazine Spring  
N. Operating Handle  
O. Recoil Spring  
P. Rotary Bolt Head  
Q. Three Shot Adapter  
R. Trigger Group  
S. Trigger Guard Retaining Nut  
T. Trigger Guard Retaining Screw

## ***General Operating Procedures***

The Browning A-500 shotgun is a shortrecoil-operated, semi-automatic shotgun. It is capable of shooting five shots (with the magazine plug removed) in rapid succession, with each pull of the trigger. The rotary bolt locks into the barrel

with four lugs. Upon firing, recoil causes the barrel to travel rearward. Energy differences between loads are absorbed by an internal breechblock spring. A special buffer surrounding the magazine tube stops the rearward motion of the barrel after about 1/2". Inertia from the barrel causes the breechblock to continue rearward, turning and unlocking the 4-lug rotary bolt, recocking the hammer, and ejecting the fired shell.

After full rearward travel, the breechblock returns forward, picking up a new shell from the magazine and chambering it automatically. After the last shell has been fired, the breechblock locks to the rear, instead of returning forward. This facilitates speedy, convenient reloading.

NOTE: The A-500 is delivered with the magazine adaptor in the magazine which limits the gun to three shots, in accordance with federal migratory bird laws. If you do not want your gun to be so limited, merely take out the three shot adapter as explained on page 42 under "Three Shot Adapter."

## ***Initial Cleaning***



Various exposed metal parts of your new A-500 have been coated at the factory with a rust

preventative compound. Before assembling your A-500, clean the anti-rust compound from the inside of the barrel, receiver and the action/chamber areas. Browning Oil is ideal for removing this compound and for giving your new gun its first lubrication. However, any quality gun oil may be used. Use a cleaning rod and patch as explained under "Cleaning and Maintenance Suggestions" on page 54.

## ***Serial Number***

---

The serial number of your A-500 shotgun is found on the left side of the receiver, at the lower rear, near the grip portion of the buttstock.

## ***Ammunition***

---

The A-500 has a 3-inch chamber and is designed to shoot and function with all 12 gauge factory loads: 3-inch Magnum, 2 3/4" Magnum, 2 3/4" High Velocity loads, 2 3/4" Field and 2 3/4" Target loads. It is especially suited to shooting factory steel shot loads. Loads can be intermixed, ***in any order***. However, Browning can assume no responsibility for incidents which occur through the use of cartridges of nonstandard dimension or those developing

pressures in excess of SAAMI (Sporting Arms and Ammunition Manufacturer's Institute) established standards.

## ***Operation of the "Safety"***

The cross bolt "safety" prevents the trigger from being pulled when in the "on safe" position. The safety is located conveniently at the rear of the trigger guard (See Figure 2). In the "off safe" or "fire" position a conspicuous red warning band is visible on the safety button on the left side of the trigger guard. To place the gun "ON SAFE," press the "safety" button to the right. To move the "safety" to the FIRE position, press the "safety" to the left.

**FIGURE 2**





An optional left-handed “safety” can be installed by a competent gunsmith. When installed, the left-handed “safety” will have the “safety” button’s red warning band on the RIGHT side of the trigger guard.

**DO NOT DEPEND ON THE RED COLOR ALONE TO INDICATE YOUR GUN’S SAFETY STATUS.** Time, exposure to the elements, as well as the abrasive action of cleaning agents can erase it.

As previously explained on page 2, never rely on your shotgun’s mechanical “safety” devices as the sole provision for safety. **NEVER POINT YOUR SHOTGUN AT ANYTHING YOU DO NOT INTEND TO SHOOT** Always treat your shotgun, even when unloaded, with the respect due any loaded, ready-to-fire firearm.

## ***Assembly Procedures      Barrel to Receiver***

The A-500 is delivered, in the box, with the barrel removed and the forearm (with recoil spring and forearm buffer inside) attached to the magazine tube. There are two ways to install the barrel on the receiver: As a barrel/forearm assembly, and part by part.

**ASSEMBLY AS A BARREL ASSEMBLY** —This is the easiest way to install your barrel on the receiver. If your A-500's forearm assembly is already removed go to step 2.

- 1** Take the receiver in hand and first, lock the breechblock rearward by pulling the operating handle fully to the rear. Then, remove the forearm, recoil spring and forearm buffer from the magazine tube by unscrewing the magazine cap and sliding the parts forward, off of the magazine tube.

**OPEN REAR END OF THE FOREARM.  
TOO MUCH PRESSURE COULD CAUSE  
THE WOOD TO SPLIT.**

- 2** Install the forearm on the barrel by sliding it over the barrel ring and seating it fully rearward.

- 3** With the barrel pointing down, insert the recoil spring in the opening at the rear of the forearm and let it slide forward fully in the forearm cavity.

- 4** Insert the forearm buffer into the same cavity in the forearm and let it slide fully forward (See Figure 3).

The recoil spring must always be installed at the muzzle end of the magazine

tube. The forearm buffer must be toward the receiver. However, both the spring and the buffer, individually, can be installed in either direction.

**FIGURE 3**



**5**

With the gun in a horizontal position, install the entire barrel/forearm assembly onto the receiver by sliding the forearm (with buffer and spring inside) over the magazine tube (See Figure 4). Position the gun vertically (barrel up), then slide the barrel/forearm assembly fully rearward, making sure that the barrel extension rails are fully seated in the receiver tracks. The barrel extension may hang up slightly where the extension contacts the face of

the rotary bolt. If it does, work the breechblock rearward very slightly by pulling rearward on the operating handle (several times if necessary), until the barrel slips into position.

**FIGURE 4**



- 6** Install the magazine cap. Make absolutely sure that the magazine cap is tightened fully, and that there is no play present in the forearm. Your A-500 is now assembled.

**PART BY PART ASSEMBLY** — If the forearm, recoil spring and buffer have already been disassembled (as after cleaning) proceed to step 2.

- 1** Disassemble the forearm assembly from the magazine tube. Take the receiver in

hand and unscrew and remove the magazine cap. Remove the forearm from the magazine tube by sliding it forward off the magazine tube.

**2**

Position the recoil spring and the forearm buffer on the magazine tube. (The forearm buffer goes on first, followed by the recoil spring.) Position them forward with the leading edge of the spring at the front edge of the magazine tube.

**3**

Hold the receiver and the magazine tube level, and at the same time position the barrel with the guide ring over the magazine tube, and the barrel extension at the receiver opening. The lower edge of the barrel extension guide must be behind the forearm buffer (See Figure 5).

**4**

Slide the barrel rearward seating the barrel extension rails in the receiver tracks. The barrel extension may hang up slightly where the extension contacts the breechblock. If it does, position the gun vertically (barrel up) and pull rearward on the operating handle, until the extension slips into position.

**5**

Slide the forearm onto the magazine tube (over the recoil spring and forearm buffer)

**FIGURE 5**

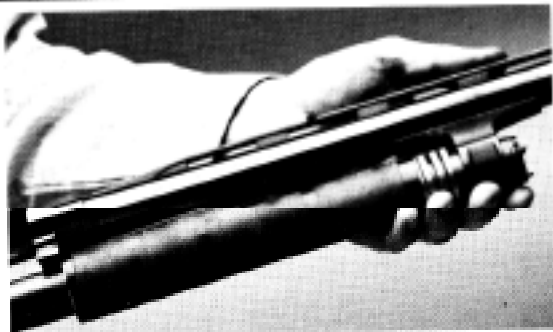

and tighten down the magazine cap snugly. Make absolutely sure that the magazine cap is tightened fully, and that there is no play present in the forearm. Your A-500 is now fully assembled.

## ***Disassembly of Barrel and Forearm Assembly***

***CHECK YOUR GUN CAREFULLY TO BE ABSOLUTELY CERTAIN THAT THE CHAMBER, FEED MECHANISM AND MAGAZINE CONTAIN NO SHELLS.***

Disassembly of the barrel is important for

cleaning and also is convenient for storing your A-500. There are two ways to disassemble your A-500. You can remove the barrel with forearm, spring and buffer attached, or remove the parts one by one.

### ***REMOVING THE BARREL WITH FOREARM ATTACHED —***

- 1** Draw the breechblock rearward and lock it open.
- 2** Unscrew and remove the magazine cap.
- 3** With one hand, grip the barrel and forearm, and pull them forward off of the magazine tube together (with recoil spring and forearm buffer inside).
- 4** For full disassembly, slide the forearm forward, over the barrel ring. The buffer and recoil spring will drop out.

### ***REMOVING BARREL/FOREARM ASSEMBLY PART BY PART —***

- 1** Draw the breechblock rearward and lock it open.
- 2** With your gun held vertically, unscrew and remove the magazine cap.

- 3** Remove the forearm by pulling it forward and off of the magazine tube.
- 4** Slide the barrel off of the magazine tube, disengaging the barrel extension from the receiver. At this point the forearm buffer and barrel spring are free to come off the end of the magazine tube.
- 5** For convenience in casing and transporting the dismantled gun, return the recoil spring, forearm buffer and forearm to their positions on the magazine tube and reinstall the magazine cap. You will then have two compact units: the barrel, and the action with forearm and stock.

***AFTER THE BARREL HAS BEEN REMOVED FROM YOUR GUN, LEAVE THE BREECHBLOCK IN THE OPEN POSITION DO NOT PRESS THE BOLT RELEASE BUTTON*** If the breechblock is released forward with the barrel removed, the operating handle will be driven against the edge of the ejection port, which will cause damage to the receiver.

## ***Loading Procedures***

There are two basic methods for initially getting a loaded shell into the chamber of your A-500.



First, the shell can be directly loaded through the ejection port. Second, a shell can be loaded manually from the magazine. In both cases, the magazine must be loaded to automatically chamber a subsequent shell. Loading the magazine and magazine capacity is also detailed below.

**CAUTION: AT ALL TIMES DURING THE LOADING PROCEDURE, BE SURE YOUR MUZZLE IS POINTING IN A SAFE DIRECTION AND THE "SAFETY" IS IN THE "ON SAFE" POSITION.**

**REMEMBER: DO NOT PUT A 20 GAUGE SHELL IN A 12 GAUGE SHOTGUN NEVER STORE SHELLS OF MIXED GAUGES IN A COMMON CONTAINER OR IN YOUR POCKETS.** See caution number 8 on page 6 of this booklet for an explanation.

**MAGAZINE CAPACITY** — With the three shot adapter installed, the magazine will hold TWO 2 3/4" or 3-inch shells. With the three shot adapter removed, the magazine holds FOUR 2 3/4" or THREE 3-inch shells.

**LOADING THE CHAMBER THROUGH THE EJECTION PORT** —

- 1** After making sure the "safety" is "on safe," pull the operating handle to the rear until the breechblock locks in the open position. Visually inspect the chamber, carrier, and

magazine to make sure they are clear of any obstructions.

**2**

While pointing the muzzle in a safe direction, hold your A-500 with the ejection port up, and insert a cartridge of the proper gauge through the ejection port into the open breech (See Figure 6). Press the breechblock release button. **KEEP YOUR FINGERS CLEAR OF THE EJECTION PORT** This will automatically cause the shell to be picked up and delivered to the chamber correctly. The chamber is now loaded.



**3**

With the chamber loaded, load the magazine to full capacity as explained below under “Loading the Magazine.”

## **LOADING THE CHAMBER MANUALLY FROM THE MAGAZINE —**

- 1** Make sure the muzzle is pointed in a safe direction and the “safety” is in the “on safe” position.
- 2** To load the magazine, follow the instructions under “Loading the Magazine” listed below. With the magazine loaded, and the breechblock closed, merely pull back on the operating handle, fully to the rear, and release it, allowing the breechblock to close. This will automatically cycle a shell from the magazine to the chamber.
- 3** To again load the magazine to full capacity, thumb another shell into the magazine as explained below under “Loading the Magazine.”

## **LOADING THE MAGAZINE —**

- 1** Make sure the muzzle is pointed in a safe direction and the “safety” is in the “on safe” position.
- 2** Close the breechblock by pressing the breechblock release button (as explained above). Make sure your fingers are clear of the ejection port.

**3**

Insert a shell, of the proper gauge, through the loading port at the bottom of the receiver, up into the magazine, using your thumb to position it fully forward in the magazine tube (See Figure 7). Repeat this procedure until the magazine is fully loaded.

**FIGURE 7**



**CAUTION: WHENEVER A SHELL HAS BEEN CYCLED INTO THE CHAMBER — AUTOMATICALLY OR MANUALLY — THE SHOTGUN IS READY TO FIRE BY SIMPLY MOVING THE “SAFETY” TO THE OFF SAFE POSITION.**

## ***Unloading your A-500***

---

***CAUTION: WHENEVER UNLOADING, ALWAYS BE CERTAIN THAT THE MUZZLE IS POINTED IN A SAFE DIRECTION AND THAT THE "SAFETY" IS IN THE "ON SAFE" POSITION.***

The recommended way to unload the A-500 is simply to grasp the operating handle and cycle the action until all rounds are ejected.

The magazine can be unloaded manually by reaching inside the loading port with your index finger, and simultaneously pressing in on the bottom of the carrier and pressing the carrier latch (See Figure 17 on page 46). Release and remove one shell at a time from the magazine, until empty.

***ALWAYS INSPECT THE CHAMBER, ACTION, CARRIER AND MAGAZINE VERY CAREFULLY AFTER UNLOADING TO BE SURE ALL LIVE ROUNDS ARE CLEARED FROM THE GUN.***

## ***Breech Remains Open                      the Last Shot***

---

The breech of the A-500 remains open, with the breechblock locked to the rear, after the last shot

has been fired. This allows convenient and fast reloading as follows:

- 1** Place the “safety” in the “on safe” position.
- 2** Drop an appropriate shell into the open breech.
- 3** Close the action by depressing the breechblock release button.
- 4** Load the magazine as explained above under “Loading the Magazine” on page 26.

***EVEN WITH THE BREECH LOCKED OPEN AFTER SHOOTING, DO NOT ASSUME YOUR SHOTGUN IS UNLOADED. ALWAYS INSPECT THE CHAMBER, CARRIER AND MAGAZINE TO BE SURE THEY CONTAIN NO CARTRIDGES. THEN, REMEMBER TO ALWAYS TREAT ANY GUN AS IF IT WAS LOADED. ALWAYS HANDLE YOUR SHOTGUN WITH CAUTION.***

## ***Operation of the Magazine cut-off***

The magazine cut-off lever is located at the front end of the left side of the receiver. This cut-off has the purpose of locking the shells in the magazine so that they will not feed into the

chamber. This permits you to quickly change the load in the chamber of the gun without going to the trouble of unloading the whole magazine. For instance, in this way a duck load can quickly be taken out and a goose load inserted, if the need arises.

To operate the magazine cutoff, merely manipulate the lever to the "MC" or "R" positions. The "MC" position engages the magazine cutoff (See Figure S-A). The "R" position (See Figure S-B) places the magazine in conventional repeater position, chambering a shell from the magazine each time the breechblock cycles rearward (as when you shoot or manually cycle the breechblock).

Also, with the magazine cutoff in operation, and with the chamber empty and the breechblock locked in the rearward position, a loaded shell may be

**FIGURE 8-A**



**FIGURE 8-B**



instantly delivered from the magazine to the chamber by merely moving the lever from the “MC” position (magazine cutoff), to the “R (repeater) position. When the breechblock is locked rearward, BE **CAREFUL TO KEEP YOUR FINGERS CLEAR OF THE LOADING PORT AND EJECTION PORT WHEN MOVING THE LEVER FROM “MC” TO “R”**

## **Full Disassembly: Trigger Group and Breech Bolt**

*NOTE: All current production A-500 shotguns have an improved trigger group assembly. You can confirm this by the letter ‘H’ stamped on the trigger guard (See Figure 10).*

*If your trigger guard does not have the letter “H” stamped on it then please contact our Browning Service Department toll tree at 1-800-322-4626 for information on how to get the improved trigger assembly installed on your A-500.*

If a malfunction occurs, or if the action becomes excessively dirty, it is advisable to disassemble the action for a complete cleaning as explained below. Detailed cleaning procedures are outlined under “Cleaning and Maintenance” on page 54. Full disassembly involves removal of the breechblock assembly and the trigger group. Any disassembly beyond this should only be



## **BROWNING A-500 SEMI-AUTOMATIC SHOTGUN**

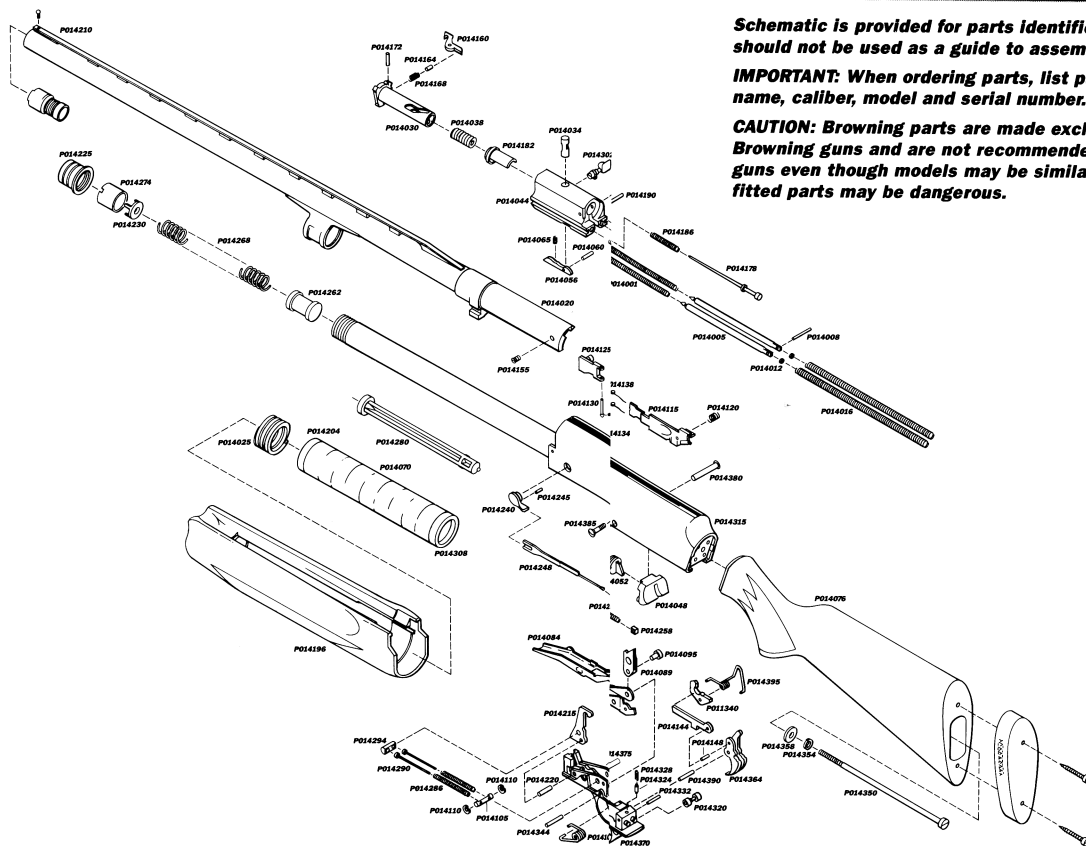

***Schematic is provided for parts identification only and should not be used as a guide to assemble guns.***

**IMPORTANT: When ordering parts, list part number, part name, caliber, model and serial number.**

**CAUTION: Browning parts are made exclusively for Browning guns and are not recommended for use in other guns even though models may be similar. Inadequately fitted parts may be dangerous.**

# Parts List

## Browning A-BB Semi-Automatic Shotgun

PART NO.	DESCRIPTION	I PART NO.	PART NAME
P014001	Action Spring Front (2)	P014190	Firing Pin Stop Pin
P014005	Action Spring Guide (2)	*P014196	Forearm
P014008	Action Spring Guide Pin	P014204	Front Ring
P014012	Action Spring Guide Washer (2)	P014210	Front Sight.
P014016	Action Spring Rear (2)	-P014215	Hammer
P014020	Barrel Extension	P014220	Hammer Pin
P014025	Barrel Spring	P014225	Magazine Cap
*P014030	Bolt	P014230	Magazine Cap Retainer
P014034	Bolt Cam Pin	P014234	Magazine Cap with Eyelet
P014038	Bolt Spring	P014240	Magazine Cutoff
*P014044	Breechblock	P014245	Magazine Cutoff Pin
-P014048	Breechblock Buffer	P014246	Magazine Cutoff Plunger
*P014052	Breechblock Buffer Core	P014254	Magazine Cutoff Plunger Spring
*P014056	Breechblock Lever	P014258	Magazine Cutoff Plunger Spring Retainer
P014060	Breechblock Lever Pin	P014262	Magazine Follower
P014065	Breechblock Lever Spring	P014268	Magazine Spring
P014070	Buffer Rings (9)	P014274	Magazine Spring Retainer
*P014076	Butt Stock	P014260	Magazine Three Shot Adaptor
*P014084	Carrier	P014266	Mainspring
*P014089	Carrier Dug	P014290	Mainspring Guide
P014095	Carrier Dug Pin	P014294	Mainspring Guide Pin
*P014101	Carrier & Carrier Dug Spring		Hammer
P014105	Carrier Pin	P014302	Operating Handle
P014110	Carrier PinCirclip (2)	P014308	Rear Ring
*P014115	Carrier Latch	*P014315	Receiver with Tube
P014120	Carrier Latch Spring	*P014320	Safety
*P014125	Cartridge Stop (Breechblock Release Button)	*P014324	Safety Plunger
P014130	Cartridge Stop & Carrier Latch Pin	P014328	Safety Plunger Spring
P014134	Cartridge Stop & Carrier Latch Pin Clip	P014332	Safety Spring Stop Pin
P014138	Cartridge Stop Spring	*P011340	Sear
*P014144	Disconnecter	P014344	Sear Pin
P014148	Disconnecter Pin	P014350	Stock Screw
P014155	Ejector	P014354	Stock Screw Lock Washer
P014160	Extractor	P014358	Stock Screw Washer
P014164	Extractor Inner Spring	*P014364	Trigger
P014168	Extractor Outer Spring	P014370	Trigger Guard
P014172	Extractor Pin	P014375	Trigger Guard Pin Sleeve
P014178	Firing Pin	P014360	Trigger Guard Retaining Nut
P014182	Firing Pin Cover	P014385	Trigger Guard Retaining Screw
P014186	Firing Pin Spring	P014390	Trigger Pin
		P014395	Trigger Spring

\* Indicates part must be fitted by Browning Service Department or qualified gunsmith.  
 † Item may be purchased only by holders of current, valid Federal Firearms License.

performed by a competent gunsmith. **ALWAYS WEAR EYE PROTECTION WHEN PERFORMING ANY MAINTENANCE OR DISASSEMBLY**

**REMOVING THE TRIGGER GROUP** – *You* will need two medium blade screwdrivers to remove the trigger guard retaining screws (the trigger guard retaining nut and the trigger guard retaining screw). Make sure the screwdrivers are of appropriate size to prevent damage to the slotted heads. No other tools are necessary.

- 1** Remove the barrel as explained under “Disassembly . . .” on page 21. Set the forearm, as well as the forearm buffer and spring, aside.
- 2** Release the breechblock to its forward position as follows: While holding the operating handle back (by applying rearward pressure) depress the breechblock release button. Allow the breechblock to travel slowly forward, controlling and slowing its forward travel until it is fully forward. The head of the rotary bolt should project about 1/2" from the front of the receiver.
- 3** Insert a screwdriver into the retaining nut slot and the other screwdriver into the retaining screw slot. Hold one side from

**FIGURE 9**



turning while unscrewing the opposite side (See Figure 9).

**4**

Remove the retaining nut and screw from the receiver.

**5**

With the gun inverted (trigger guard up), grasp the trigger guard and pull it up, forward and out from the receiver (See Figure 10). **DO NOT DISASSEMBLE THE TRIGGER GROUP BEYOND THIS POINT** Perform all cleaning with the trigger group kept intact as an assembly

*REMOVING THE BREECHBLOCK* – Normal procedure is to remove the trigger group first, as explained previously.

**FIGURE 1**



- 1** Remove the operating handle as follows:  
With your left hand, push on the bolt head moving the breechblock about  $\frac{1}{2}$ " back into the receiver, lining up the operating handle with the notch at the bottom front of the ejection port (See Figure 11-A). With your right hand grasp the operating handle and pull it outward, removing it from the breechblock (See Figure 11-B).
- 2** The breechblock will now be able to move forward about another  $\frac{1}{2}$ ". Again, push rearward on the bolt head, depressing the breechblock back into the receiver about  $\frac{1}{4}$ ". With your right hand, reach in with a finger and push on the breechblock lever

**FIGURE 11-A**

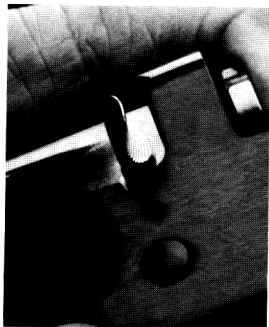

**FIGURE 11-B**



**FIGURE 12**

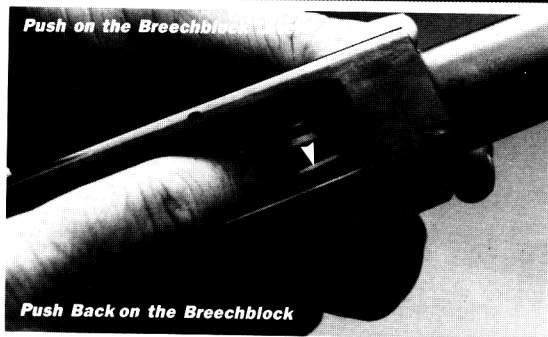

found on the bottom side of the breechblock (See Figure 12). The breechblock lever serves to retain the breechblock in the receiver.

(SPECIAL NOTE: It is possible to remove the breechblock first before removing the trigger group. You will need simultaneously push rearward 1/4" on the breechblock and "reach" in through the opening at the front of the carrier to depress the breechblock lever, using the eraser end of a pencil, a small wood dowel, a screwdriver, or other similar object.)



With the breechblock lever pressed, remove the breechblock forward, out of the front of the receiver. The action springs will stay attached to the breechblock, projecting from the rear. The breechblock is now fully removed. **DONOTDISASSEMBLE THE BREECH BLOCK BEYOND THIS POINT.**

## ***Reassembly: Trigger Group and Breechblock***

### **REINSTALLING THE BREECHBLOCK ASSEMBLY**

- 1** Insert the breechblock into the receiver opening, action springs first. The guides on

the breechblock must fit in the receiver tracks. Make sure the front action springs fit over the ends of the action spring guides (See Figure 13). Push the breechblock in far enough that the breechblock lever engages, holding the breechblock in the receiver.

**FIGURE 13**

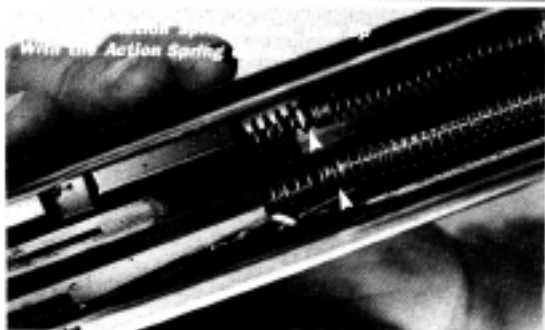

Simultaneously push back on the breechblock while depressing the breechblock release button until the notch in the ejection port lines up with the operating handle recess on the breechblock. Make sure that the action springs are compressed inside the recesses in the breechblock, and that the ends of the action spring guides start into



the recesses in the breechblock without kinking the front action springs.

- 3** Insert the operating handle into the recess (See Figure 11-A on page 37). The breechblock is now installed.

### ***REINSTALLING THE TRIGGER GROUP —***

- 1** Reinsert the trigger group into the bottom of the receiver, moving it rearward to assure correct location of the rear pins into the holes in the receiver. Then start at the back and hinge the trigger guard forward (See Figure 14).

**FIGURE 14**



2

Line up the hole in the trigger guard with the holes on each side of the receiver. Insert the trigger guard retaining nut completely through the receiver. Start the retaining screw with your fingers and tighten using two screwdrivers, one for each slotted head on each side of the receiver.

## ***Three-Shot Magazine Adapter***

The following instructions are for disassembly of the magazine, and the removal or installation of the three-shot magazine adapter. Steps 1-8 detail magazine disassembly, and are the same for both removal and installation of the three-shot adapter. Steps 9-A and 9-B explain reassembly of the magazine *with or without the* three shot adapter.

The A-500 shotgun is delivered with the three-shot magazine adapter installed in the magazine, limiting magazine capacity to two shells – allowing three shots total in compliance with federal migratory bird regulations. If you do not wish to be limited to three shots – when it is not required by law – you can remove or reinstall the three-shot adapter (plug) as follows:

***ALWAYS WEAR PROTECTIVE SAFETY GLASSES DURING THIS OPERATION.***

- 1** Unscrew the forearm cap and remove the forearm, **BARREL**, forearm buffer and recoil spring from the gun as explained under “Disassembly of Barrel and Forearm Assembly” on page 21. **UNDER NO CIRCUMSTANCES SHOULD YOU PERFORM THE FOLLOWING PROCEDURES WITH THE BARREL ATTACHED.**
- 2** Reinstall the magazine cap on the magazine tube *approximately one turn* engaging at least **ONE FULL TURN OF THREADS** solidly.
- 3** Release the breechblock forward slowly by pressing the breechblock release button and slowly allowing the breechblock to travel forward. Do this by pressing the button with one hand and offering resistance on the operating handle with the other hand, gently easing it forward to the fully forward position.
- 4** Pull back approximately 1/4" of an inch on the operating handle. With your other hand insert two 2 3/4" (or two 3-inch magnum shells) into the magazine if you are *removing* the three-shot adapter **OR** insert four 2 3/4" shells (or three 3-inch magnums) if the three-shot adapter was removed previously and you are *reinstalling* it. Position an additional shell as if you were going to insert it into the

magazine (it will stop only partially inserted because of the full magazine).



Apply steady, hard pressure on the shell, pushing all the shells forward in the magazine until the magazine spring retainer is dislodged from its compressed fitting at the end of the magazine (See Figure 15). You will feel forward movement of the shells in the magazine when it is dislodged.



**IF IT WILL NOT DISLODGE WITH STEADY PRESSURE** *you* may have to work the last shell in and out to increase force on the shells in the magazine.

If this also fails to dislodge the magazine spring retainer, place another shell behind the one

partially inserted and apply increased pressure with the palm of your hand, or strike the back of the last shell with the palm of your hand until the retainer is dislodged (See Figure 16).

**NOT USE ANY OTHER OBJECT THAN THE PALM OF YOUR HAND TO APPLY PRESSURE TO THE LAST SHELL.**

**FIGURE 16**



**6**

With the retainer dislodged, **IMMEDIATELY REMOVE THE SHELLS FROM THE MAGAZINE. DO NOT UNSCREW THE MAGAZINE CAP WITH SHELLS IN THE MAGAZINE.** Remove the shells by first pulling back approximately on the operating handle. Then release the shells from the magazine by reaching inside the

loading port and simultaneously pressing in on the bottom of the carrier and pressing the carrier latch with your finger (See Figure 17). Release and remove one shell at a time from the magazine.

**IMMEDIATELY PUT ALL THE SHELLS AWAY IN YOUR AMMUNITION STORAGE AREA — AWAY FROM YOUR A-500 AND OTHER GUNS.**

**FIGURE 17**



**7**

Carefully unscrew the magazine cap from the magazine. **CAUTION: THE MAGAZINE SPRING IS UNDER TENSION AND WILL FORCE OUT THE RETAINER, THREE SHOT ADAPTER AND THE SPRING ITSELF UNLESS CARE IS TAKEN.** Slowly

lift the magazine cap off of the magazine. At the same time, catch the spring with your other hand as it begins to come out (See Figure 18). If already installed, the three shot adapter will be on top of the magazine spring.

**FIGURE 18**



**8**

Remove the spring and adapter, if present, from the magazine tube. Remove the magazine spring retainer from the inside of the magazine cap. The magazine follower can be removed by pointing the magazine tube downward and dumping it out.

**9A**

### **REASSEMBLY WITH THE THREE-SHOT MAGAZINE ADAPTER INSTALLED**

To reassemble the magazine with the

three-shot adapter installed, first, position the gun vertically, butt down. Then reinstall the magazine follower in the magazine tube, closed end first. Place the three-shot adapter inside one end of the magazine spring, small end first. Place the magazine spring retainer over the top of the adapter. Insert the other end of the magazine spring into the magazine tube and compress it into the magazine tube (See Figure 19). With hand pressure, seat the magazine spring retainer fully into the compression fitting on the end of the magazine tube.

**FIGURE 19**







## **REASSEMBLY WITHOUT THE THREE-SHOT MAGAZINE ADAPTER.**

Reassembly of the magazine without the three-shot adapter is identical to step 9-A with one exception: after inserting the magazine follower into the magazine tube, place the magazine spring retainer directly on the end of the magazine spring. Then insert the other end of the magazine spring into the magazine tube and compress it into the magazine tube. With hand pressure, seat the magazine spring retainer fully into the compression fitting on the end of the magazine tube.

Reassembly of the magazine, and removal/installation of the three-shot magazine adapter is now completed. To prepare for replacing the barrel and forearm on your A-500, pull the operating handle on the breechblock fully rearward, locking the breechblock back. You are now ready to reinstall the barrel/forearm assembly to the receiver as outlined in “Assembly Procedures-Barrel to Receiver” on page 16.

# ***Investor Interchangeable Choke System***

All A-500 shotgun barrels have been threaded to accept the Browning Investor Interchangeable Choke System. You may confirm this by looking on the right side of your barrel where the specifications are inscribed, and where the choke markings are normally located. The word INVECTOR denotes that the barrels are threaded. The degree of choke tube is indicated twice on each choke tube: Inscribed on the side of the tube, and indicated with a “notch” code on the top rim of the tube.

Investor Choke Tubes are made with tempered steel and are fully compatible with all FACTORY AMMUNITION (loaded in compliance with SAAMI specifications) including Magnum lead and steel shot loads and rifled slug loads.

***DO NOT FIRE THIS SHOTGUN WITHOUT HAVING AN INVECTOR CHOKE TUBE INSTALLED***  
Permanent damage may result to the threads.

***DO NOT USE BROWNING INVECTOR CHOKE TUBES IN ANY SHOTGUN BARRELS NOT SUPPLIED BY BROWNING. ALSO, DO NOT USE ANY OTHER CHOKING DEVICE IN ANY SHOTGUN BARREL SUPPLIED BY BROWNING. USE ONLY CHOKE TUBES MARKED INVECTOR***

**CAUTION: WHENEVER HANDLING ANY SHOTGUN FOR THE PURPOSE OF REMOVING OR INSTALLING A CHOKING DEVICE, MAKE ABSOLUTELY CERTAIN THE GUN IS FULLY UNLOADED, AND THE BOLT OR BREECH IS OPEN! NEVER ATTEMPT TO REMOVE OR INSTALL A SHOTGUN CHOKING DEVICE ON A LOADED FIREARM!**

### **TUBE REMOVAL-**

- 1 UNLOAD YOUR A-500 FULLY INSPECT THE CHAMBER, FEED MECHANISM AND MAGAZINE TO MAKE SURE THEY DO NOT CONTAIN ANY SHELLS.**
- 2** Open the action, locking it rearward, and place the “safety” in the “on safe” position.
- 3** Use the Invictor wrench to loosen the tube, turning it counterclockwise. Fingertwist the tube the rest of the way out of the barrel.

### **TUBE INSTALLATION**

- 1 UNLOAD YOUR A-500 FULLY INSPECT THE CHAMBER, FEED MECHANISM AND MAGAZINE TO MAKE SURE THEY DO NOT CONTAIN ANY SHELLS**

- 2 Open the action and place the “safety” in the “on safe” position.
- 3 Before installing a tube, check the internal choke tube threads in the muzzle, as well as the threads on the Invector choke tube to be sure they are clean. Lightly oil the threads with an oil like Browning Oil.
- 4 Using your fingers screw the appropriate tube into the muzzle end of the barrel, tapered end first, notched end outward. When it becomes finger-tight, use the Invector choke wrench to firmly seat the tube.

***THE INVECTOR CHOKE TUBE SHOULD BE PERIODICALLY CHECKED TO ASSURE THAT IT IS TIGHT AND FIRMLY SEATED. BEFORE CHECKING, FOLLOW THE SAFETY GUIDELINES OUTLINED ABOVE.***

Replacement and additional tubes and wrenches are available from your Browning dealer, or by writing to the Browning Consumer Department, Route 1, Morgan, Utah 84050. (801) 543-3200.

Canadian customers please call or write to Browning Canada Sports Ltd./Ltee, 3167 De Miniac, St. Laurent Canada H4S 1S0 (514) 333-7261.

***INVECTOR CHOKE TUBE CODE*** — To identify individual Invector tubes, refer to the abbreviated indications on the side of the tube,

or use the identification mark(s) located on the top rim of each tube (See Figure 20).

## INVECTOR TUBE SELECTION

This chart shows lead/steel choke constriction designations for each Invector tube within each gauge. Designation is listed lead first, then steel: for example, M/F means a certain tube shoots Modified with lead shot and Full with steel shot. Tubes listed are also available as accessories.

**FIGURE 20**

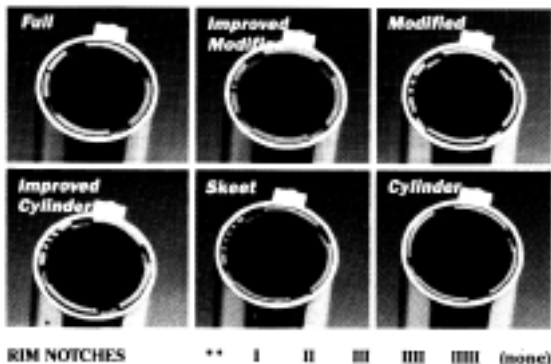

12 Gauge lead/Steel

XF/\*\* F/\*

IM/F† M/F† IC/M SIC† C/C†

**Tube Code:** XF-Extra Full, F-Full, IM-Improved Modified, M-Modified, K-Improved Cylinder, S-Skeet C-Cylinder

\*Do not use with steel shot. Using an over-tight choke constriction with steel shot will result in an ineffective, "blown" pattern.

\*\*Extra Full Special with knurled rim and no rim code. Do not use with steel shot.

When more than one choke designation is listed for a given steel shot pattern, use the more open choke listed for high velocity larger shot size steel shot loads.

## ***Use of Extra Barrels***

On all Browning A-500 shotguns, barrels of the same gauge are completely interchangeable, and no special fitting is required. Thus, by merely buying another barrel of a different length, or for a different purpose (such as a Buck Special barrel), and using the appropriate Invector choke tube, you have acquired the utility of another gun at a fraction of the cost of a new gun; a duck gun becomes a fine upland game gun, a pheasant gun becomes a rifled slug deer gun.

## ***Sight Adjustment for Buck Special Barrels***

Buck Special barrels are equipped with a precision rear sight which is screw adjustable for both horizontal and vertical correction.

***WINDAGE ADJUSTMENT*** — To move point of impact to the RIGHT, loosen the small screw on the right side of the sight. Then tighten the small screw on the left side of the sight. To move point of impact to the LEFT loosen the small screw on the left side of the sight and tighten the screw on the right side. This is a process of trial and error. Make small adjustments then check the point of impact.

**VERTICAL ADJUSTMENT** — Adjustment of the sight is controlled by the screw located on top of the sight. To RAISE the point of impact, turn the screw in a counterclockwise direction. To LOWER the point of impact, turn the screw in a clockwise direction. Vertical adjustment is also a process of trial and error.

## ***Cleaning and Maintenance Suggestions***

---

You should clean your A-500 whenever it becomes excessively dirty — and perform a thorough cleaning at least once a year. The barrel should be cleaned, and the action wiped clean and oiled after every day of shooting. If a malfunction occurs, perform a thorough cleaning, to see if it solves the problem, before seeking the services of a Browning Recommended Service Center, the Browning Service Facility in Arnold, Missouri, or a competent gunsmith.

Normal maintenance can be accomplished with the barrel still attached to the receiver (oiling and wiping down). More careful cleaning requires removal of only the barrel from the receiver (cleaning the barrel). A complete cleaning requires removal of the breechblock and trigger group.

**PERIODIC OILING** —Ordinary good judgment will indicate that the metal parts of the gun should receive a light film of oil after the gun has been exposed to weather or handling. Occasionally, a small drop of oil may be placed on each receiver track in which the barrel extension guides and breechblock run during operation (See Figure 21). This will help to relieve friction and ensure smooth operation.

**FIGURE 21**



Also, lightly lubricate the breechblock, rotary bolt and spring guides. **DO NOT POUR LARGE QUANTITIES OF OIL INTO THE ACTION.** A large excess of oil will run back into the wood of the stock and cause softening of the wood, with consequential loosening of the stock.



**CLEANING PROCEDURES** — The correct procedure for cleaning your A-500 shotgun is as follows:

**1** ***BE CERTAIN YOUR SHOTGUNS MAGAZINE, FEED MECHANISM AND CHAMBER ARE UNLOADED. PLACE THE “SAFETY” IN THE “ON SAFE” POSITION. ALWAYS WEAR PROTECTIVE SAFETY GLASSES DURING ALL DISASSEMBLY AND CLEANING PROCEDURES.***

**2** Remove the barrel so that it can be cleaned from the breech end (See “Disassembly ...” on page 21).

**3** Using a shotgun cleaning rod with tip and patch large enough for a snug fit in the bore, insert the rod and patch in the breech end of the barrel and run back and forth through the bore several times. Remove and wipe the tube, tube threads and barrel threads, and lightly oil.

**4** Inspect the bore from both ends for leading by looking through bore toward light. Leading will appear as dull longitudinal streaks and is usually more predominant near the muzzle and just forward of the chamber.

**5** A normal amount of leading can be expected with today's high velocity loads and improved wads but this is not serious. If or when leading should become heavy, it can be removed with a brass bore brush. Make sure a choke tube is installed. Spray the bore or the bore brush with a good powder solvent, and scrub the bore until leading is removed. To prevent brass bristles from breaking off, the brush should be pushed completely through the bore before being withdrawn.

**6** After leading has been removed, the bore should be wiped dry with a clean patch, and then a lightly oiled patch run through it for preservation.

**7** If the gun has been exposed to much dust, dirt, mud or water, the principal working parts should be wiped clean and lubricated with a light film of oil. Browning Oil is recommended.

**8** Remove the forearm buffer and recoil spring. Wipe the magazine tube clean of all dirt and grit. Lightly oil and wipe dry

When the action becomes excessively dirty, remove the trigger group and breechblock assembly from the receiver as

explained under “Full Disassembly ...” on page 31. Clean with an oil such as Browning Oil or a gun solvent as necessary, using an old toothbrush to loosen any caked-on grime. Wipe the receiver cavity clean. Lightly oil the cavity (aerosol Browning Oil is ideal) and wipe it dry. No further disassembly is required for cleaning.

**10**

Reassemble the trigger group, breechblock, and the barrel to the receiver. Then wipe all exposed metal surfaces with an oiled cloth making sure to wipe your A-500 clean of all finger marks where moisture will accumulate.

**11**

The barrel and action should be inspected to assure that all cleaning patches have been removed and not inadvertently left in the barrel or action.

**12**

The wood surfaces can also be wiped with Browning Oil or they can be polished with any quality furniture wax (but not both).

***DO NOT TAKE YOUR GUN'S ACTION APART BEYOND THE EXTENT EXPLAINED IN THIS***

***MANUAL*** This is a specialized, finely fitted mechanism, and you may mar it for life by an attempt to disassemble the inner mechanism assemblies. Do not disassemble the breechblock and trigger group more than described. If further disassembly is required, take your gun to a Browning Recommended Service Center or a competent gunsmith.

## ***Service or Repair***

If your A-500 should require service or repairs, we suggest you first contact a local recommended Browning Firearms Service Center. Your Browning Sporting Goods dealer can tell you the address of the Service Center nearest you, or you may call or write our Consumer Information Department in Morgan, Utah (801) 543-3200. Otherwise you may return your shotgun to our own repair facility for servicing. The address is:

***Browning Service Department  
3005 Arnold Tenbrook Road  
Arnold, Missouri 63010-9406  
Phone: 1-800-322-4626***

Canadian Customers call or write:

***Browning Canada Sports Ltd./Ltee,  
3167 De Miniac, St-Laurent, Quebec H4S 1S0  
(514) 333-7261***

When returning your A-500 for servicing, please be sure it is unloaded, and that it is packaged securely in a cardboard container. Under no circumstances should ammunition be returned as it is against postal and most commerce regulations. **YOU *MUST ENCLOSE A LETTER WITH THE GUN*** that clearly describes the trouble experienced and the repairs or alterations desired.



## **SPORTING ARMS**

World famous for handcrafted quality and dependability Browning Sporting Arms Include a complete line of shotguns and high power or small bore caliber rifles and pistols



## **BROWNING PRO-STEEL GUN SAFES**

Protect your guns and other valuables from today's rising theft rate. No other safe gives you the protection you get from Browning Pro-Steel's Gold Series safes; reinforced door and door frame, extensive hard plate, heavy steel plate construction, and independent, active locking lugs.

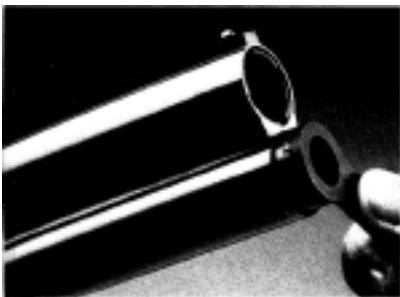

## **INVECTOR CHOKE TUBE SYSTEM**

Most Browning shotguns are available with the Invector Choke Tube system Tubes for all popular chokes install in seconds and recess completely inside the muzzle No projecting knurled rings or flanges to distract your aim or spoil the looks of your Browning shotgun



## SPORTSMAN'S **BOOTS** **PACKS AND WADERS**

Browning boots are known for their comfort and long wear. They're built from the finest materials and leathers with features like Dual-Waterproof™ construction found on all Nomad series Gore-Tex® boots. A waterproof outer shell and inner Gore-Tex® bootie doubles your assurance of dry feet.

You'll cover more ground with less effort wearing a pair of our famous lightweight boots.



## **BROWNING** **HOLSTERS AND** **PISTOL CASES**

Browning has a complete selection of hand-tooled, basketweave holster designs in genuine leather for all Browning pistols, as well as flexible cases in Cordura nylon, vinyl or heavy gauge canvas duck.

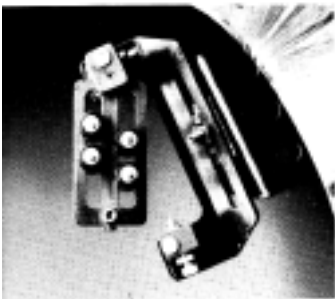

## **ARCHERY** **ACCESSORIES**

You can completely outfit your Browning bow with accessories to meet all types of hunting and target situations. Specialty sights, quivers, arrow rests, bow cases, gloves and arm guards are just a few of the accessories offered.



## **SPORTSMAN'S CLOTHING**

Hunting, fishing, or treks to the shopping mall, you know that your Browning clothing will do its job well. For the sportsman who spends time in wet, cold weather, Browning has a complete line of waterproof Gore-Tex® clothing. Hats, gloves and handsome leather belts are also available.



## **ARCHERY EQUIPMENT**

Browning has a complete line of compound bows suited for recreation and hunting. Handsome styling, coupled with exceptional speed and accuracy is something you can count on with every Browning bow. There is a draw weight, draw length, and bow size for nearly every shooter.



## **GUN CASES**

Your guns are well protected in a Browning flexible gun case. Exteriors of genuine leather, attractive vinyl, rugged canvas or tough, water-repellent Cordura nylon are available for nearly any size gun. Soft inner linings protect your gun's finish. Our luggage cases are of scuff resistant, leather-textured vinyl and lined with polyester fleece fabric, giving you unmatched protection for your Browning shotguns and rifles.

# Other Browning Products



## **SPORTSMAN'S KNIVES**

There is a folding or fixed blade Browning knife to match nearly every requirement — including fillet pocket skinning and general utility style knives. Every Browning knife is manufactured using the finest materials and the most hand-pleasing designs. Each Browning knife is distinctive in quality and style the way a good knife should be.



## **FISHING TACKLE**

You'll catch more fish and have more fun with a quality Browning fishing rod or reel. There's a rod for every fishing trip — from pack rods for traveling to heavy rods for deep sea action. Top quality reels come in sizes for practically any fishing situation. Also choose from Browning's complete line of quality accessories.



## **BROWNING OIL**

Browning Oil is the best all-around oil for your guns. It cleans, lubricates, and protects metal and blueing. It is designed to function in extreme temperatures and provides excellent anti-rust protection. Browning Oil is also ideal for many other applications including household, automotive, and fishing tackle. Available in drip spout or aerosol.